

LUBRICATION SYSTEM FOR AGRICULTURE MACHINERY





Company Introduction

Company⁺

Introduction

Yantai Ciso Lubrication Technology Co., Ltd. is a high-tech enterprise specializing in R&D, production and sales of centralized lubrication systems and hydraulic equipment. The centralized lubrication systems produced by our company have the characteristics of high stability, strong reliability, good sealing, and high output pressure. The products and services currently have covered petrochemical, wind power generation, construction machinery, agricultural machinery, rail transit, medicine and other industries, and it is a leading solution provider in the industry.

The company adheres to the concept of "integrity-based, quality first, and continuous innovation" to provide customers with A+ ideal solutions to meet the different needs of customers. Through years of research and development and production practice, from product design to accessories selection , product assembly, finished product testing and sales services, to ensure product quality.

Certificate



CONTENTS

CONTENTS

目录

Grease lubrication systems

Main components of system	1
GT pump	2
GM samll pump	14
DSP distributor	22
VB distributor	28
Manual Grease lubrication system components	36
Product application cases	37

Chain lubrication systems

Main components of system	39
PMV pump	40
PMM pump	46
PMN pump	48
Product application cases	50

Accessories

Grease lubrication system accessories	51
Chain lubrication system accessories	67

Grease lubrication system

Grease lubrication system is mainly divided into two kinds, one is electric centralized lubrication system, The second is the manual centralized lubrication system. The biggest difference between the two systems is the electric system The dynamic degree is higher, and the detection function can be realized.



Main components of system

GT pump



- Electric high voltage、Max. 35Mpa
- Max. 5 Unit of pump outlets
- Controller available
- Oil-NLGI2#Grease
- The pump body is strong and UV resistant

GM pump



- Electric high voltage、Max. 25Mpa
- Max. 5 Unit of pump outlets
- Controller available
- Progressive and Single-line lubrication system
- Smaller mounting size
- The pump body is strong and UV resistant

GW pump



- With top cover, easy to fill oil
- Electric high voltage、Max. 35Mpa
- Max. 5 Unit of pump outlets
- Controller available
- Oil-NLGI2#Grease
- The pump body is strong and UV resistant

Progressive distributor

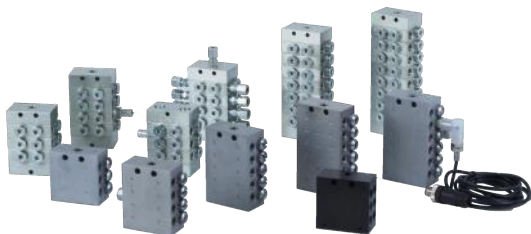

The pump makes the lubricant flow from the main road to the progressive distributor at all levels, "progressive" delivery to each lubrication point. The working cycle of the progressive distributor is monitored by a visual or electronic control system



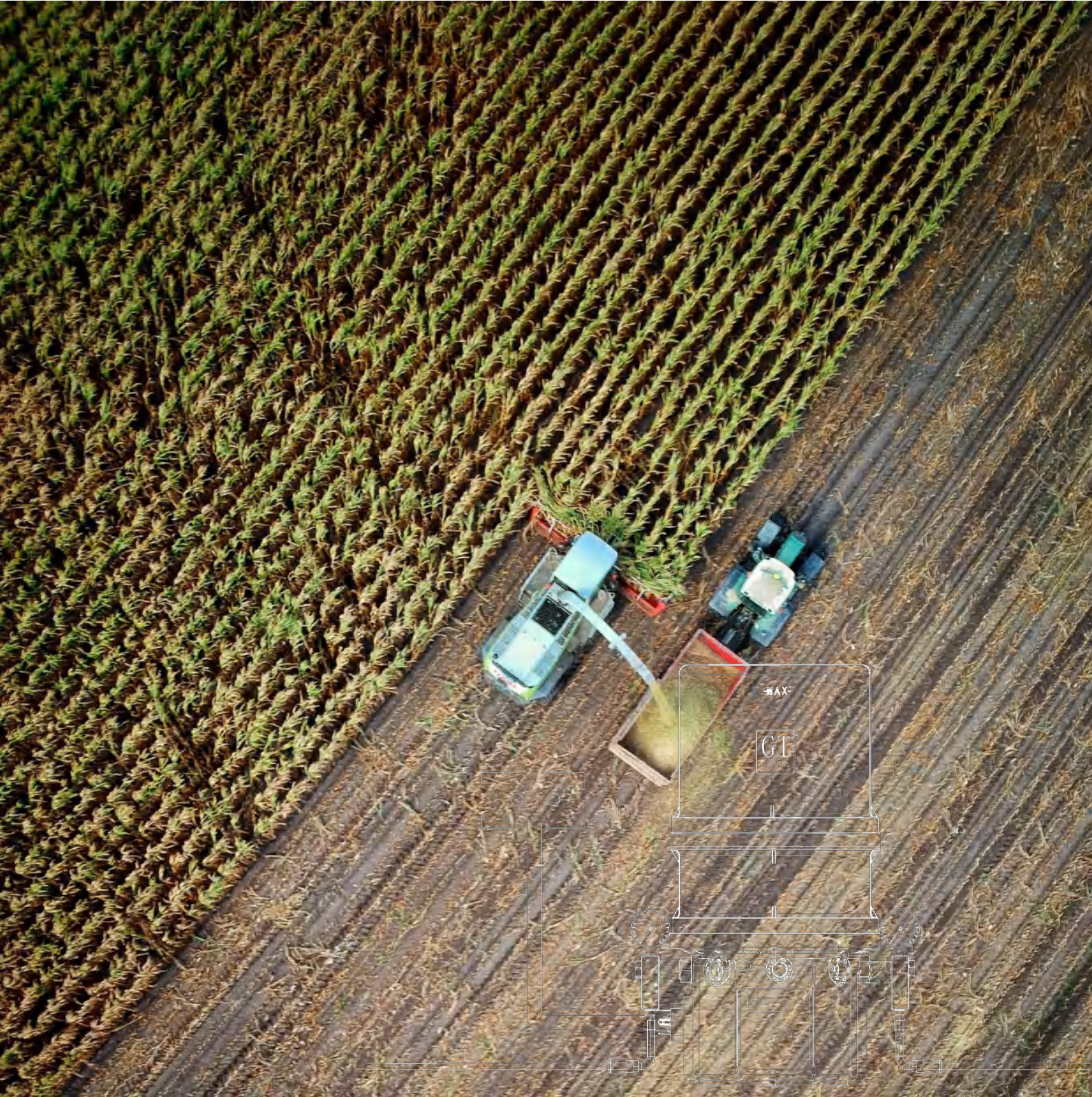

GT PUMP

- Pump oil and grease
- Multiple grease filling ways
- Powerful centralized control system
- Multiple voltages are available

THE SMALL PUMP PACKAGE WITH BIG FEATURES

DESIGN AND ADVANCED SOLUTIONS

GT pump is a piston pump predisposed to operate with a maximum of five pumping units. Its design is particularly suitable for progressive systems or single-line systems. Five independent line lubrication at the same time. Output can be combined and increase displacement.

With special materials, to achieve excellent anti-shock ability. Special design of pump make it easy to observe the oil level and prevent UV radiation, prevent oil deterioration. With low liquid level alarm, flashing buzzer. Also can choose the type of output.

Standard: can be managed by an external PLC. Since it does not come with an internal control unit, this is the most economic solution for lubricating your systems.

Automatic: With integrated control system, which can be set up local running time. Equipped with local operation and alarm light, alarm with buzzer, provide low level and pulse alarm, which can be combined with the monitor of distributor units into a perfect operating system.



Characteristics

- Pump oil and grease
- Reservoirs: 2L、 4L、 6L、 8L、 12L
- Voltages: 12VDC、 24VDC、 90-240VAC
- Multiple grease filling ways
- Powerful centralized control system
- CE Certification
- Design patent
- IP67

Application

- Construction machinery
- Agricultural equipment
- Wind power equipment
- Press machine
- Mining equipment
- Ship and Marine engineering
- Food and drinking
- Textile

.....

TECHNICAL CHARACTERISTICS	
Unit of pump outlets	Max 5 outlets
Outlet thread	G1/4
Rated flow	2ml、 3ml、 4ml/min
Operating pressure	35MPa Max
Reservoir Capacity	2、 4、 6、 8、 12L
Lubricants	OIL、 000、 00、 0、 1、 2
Operating temperatures	-50 - 90°C*

* When the operating temperature is below -20 ° C, please use low temperature grease



Control Sysem:

**Basic function**

- ① Easy to read LED display
- ② Legible on/off instructions
- ③ Reset function
- ④ Easy to use navigation keys
- ⑤ Alarm signal of lube system shutdown
- ⑥ Warning signal prior to lube system shutdown
- ⑦ Low level indication
- ⑩ Manually run/Confirm

Custom function

- ⑧ Access to the control device is password protected
- ⑨ Pre-lube capability

★ For additional customization features, please contact your sales manager.

- Clear panel
- Programs that can be designed
- It can be password protected
- Sound alarm
- Low level alarm
- Accept proximity switch
- Excellent shock resistance
- pre lubrication button

Press and hold the "↑+↓" keys at the same time to enter the setting mode, Press  to enter page browsing.

Set run time

The LED adjacent to the ON part of the clock lights up, indicating that you are setting the boot time parameters, you can press "↑or↓" to adjust the time.

Set shutdown time

The LED adjacent to the OFF section clock lights up to indicate that you are setting the shutdown time parameter. Press "↑ or ↓" to adjust the time.

Press  to start running



GT Pump

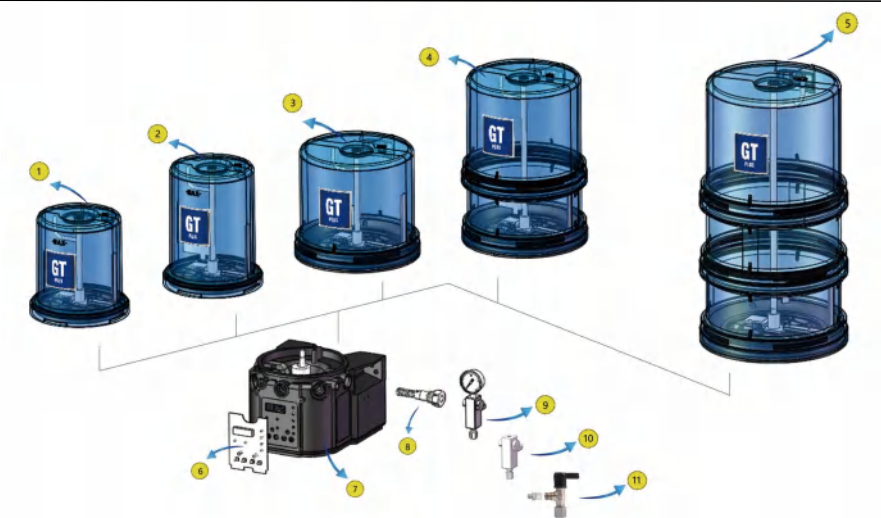

NO.	PART	NO.	PART
1	2L Pump Tank	7	Pump base
2	4L Pump Tank	8	PLUS Pumping Element
3	6L Pump Tank	9	Pump outlet assembly (With pressure gauge)
4	8L Pump Tank	10	Pump outlet assembly (Without pressure gauge)
5	12L Pump Tank	11	With Relief valve
6	Control panel		

2L & 4L Dimensions(mm):

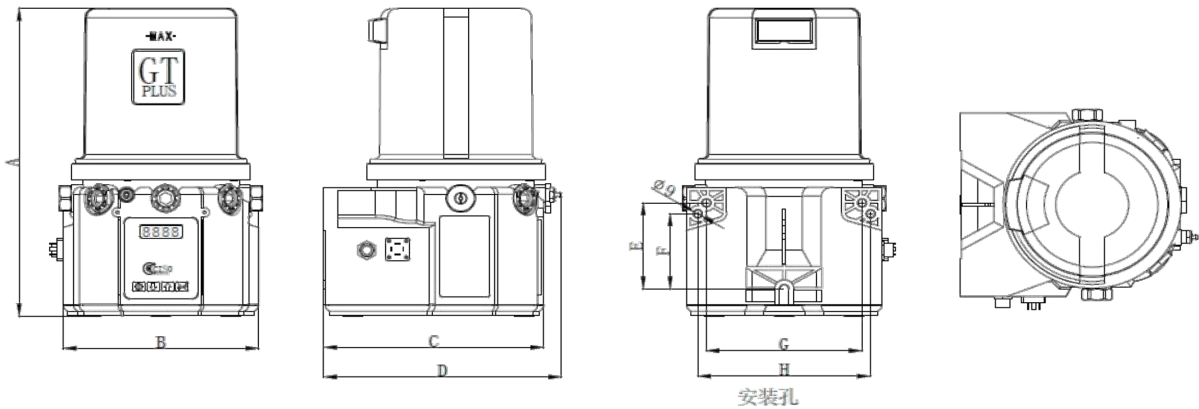

Reservoirs	A	B	C	D	E	F	G	H
2L	338	204	229.5	248	95.5	83.5	162.5	180
4L	378	204	229.5	248	95.5	83.5	162.5	180



6L Dimensions (mm):

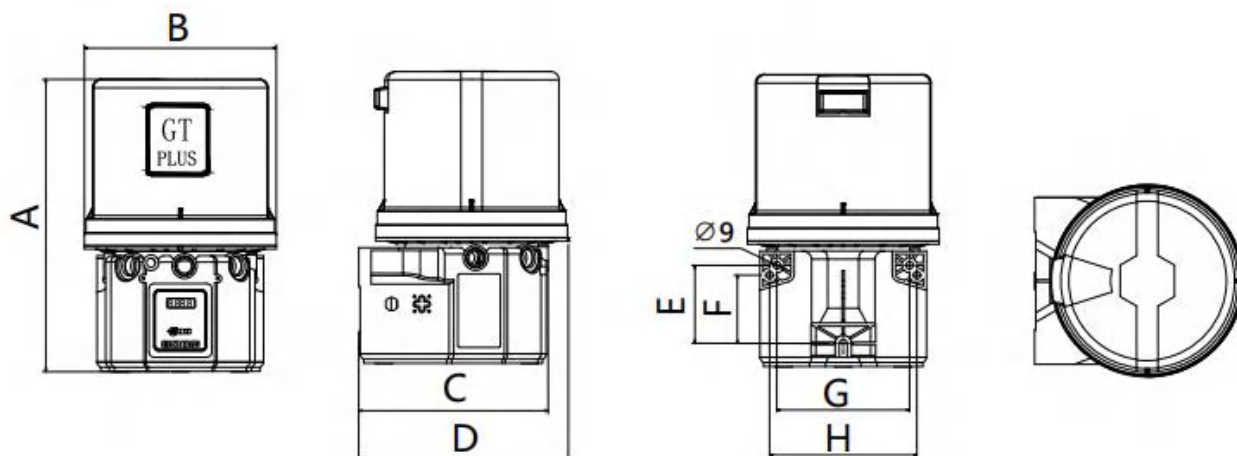

Reservoirs	A	B	C	D	E	F	G	H
6L	358	235	231.5	256.5	95.5	83.5	162.5	180

8L & 12L Dimensions (mm):

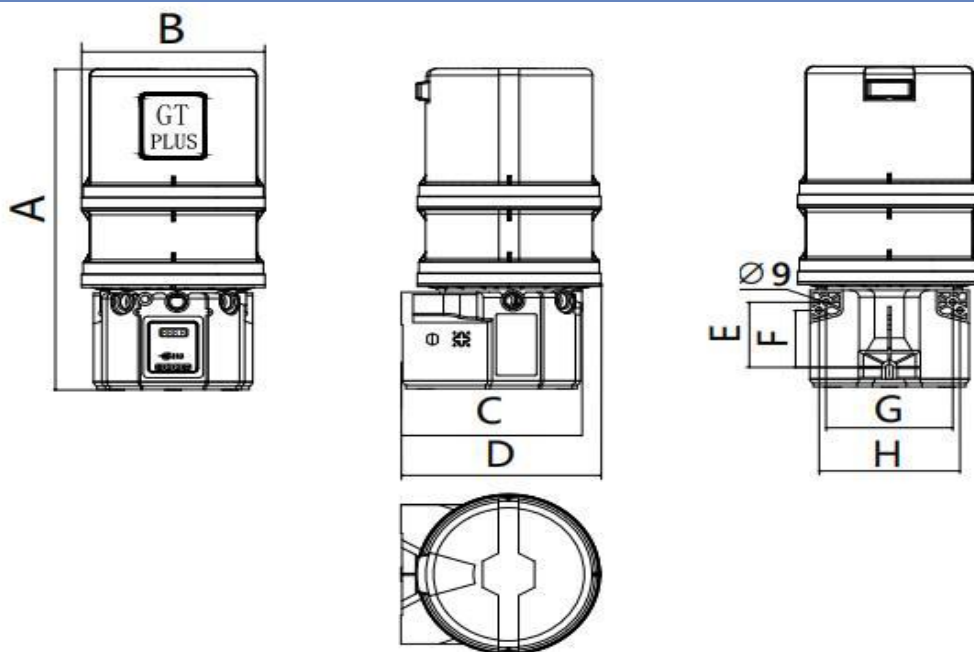

Reservoirs	A	B	C	D	E	F	G	H
8L	471	235	231.5	256.5	95.5	83.5	162.5	180.5
12L	585	235	231.5	256.5	95.5	83.5	162.5	180.5



GT Pump

Top cap:

1. Order the GT pump for the upper grease cover. Please add - B after the standard part number.
For example: 20D220-B



Pump grease, top open cover mode, large diameter injection cap
Applicable: 2L、 6L、 8L、 12L
This top cover method is not suitable for 4L

2L Dimensions (mm) :

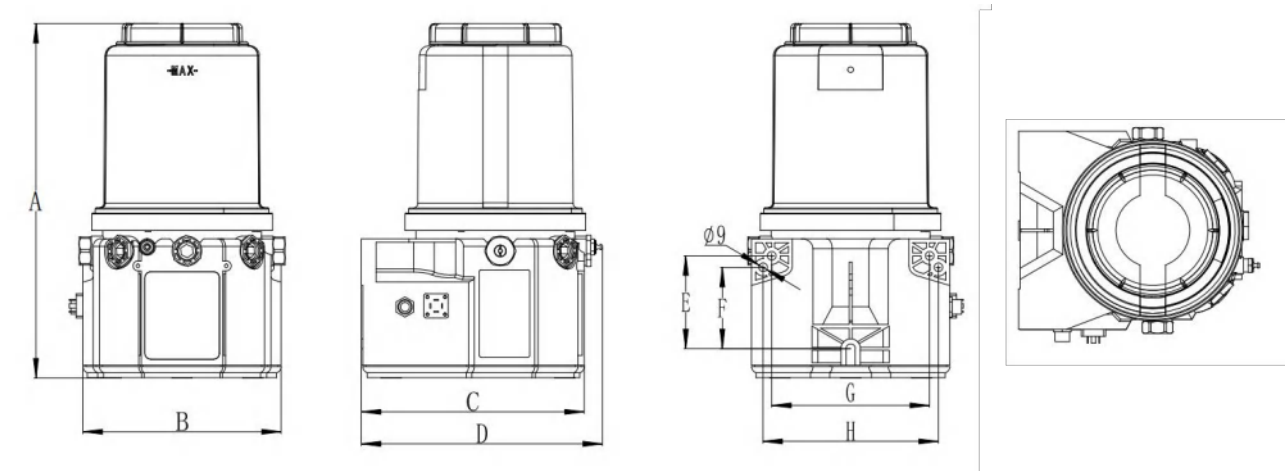

Reservoir	A	B	C	D	E	F	G	H
2L	365	204	231.5	248	95.5	83.5	162.5	180.5



6L & 8L Dimensions (mm) :

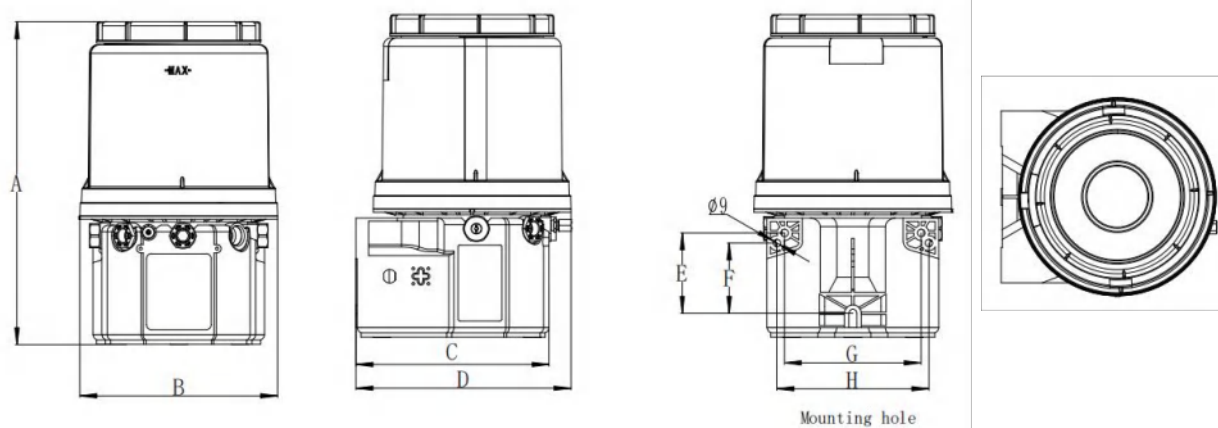

Reservoir	A	B	C	D	E	F	G	H
6L	385	235	231.5	255.5	95.5	83.5	162.5	180.5

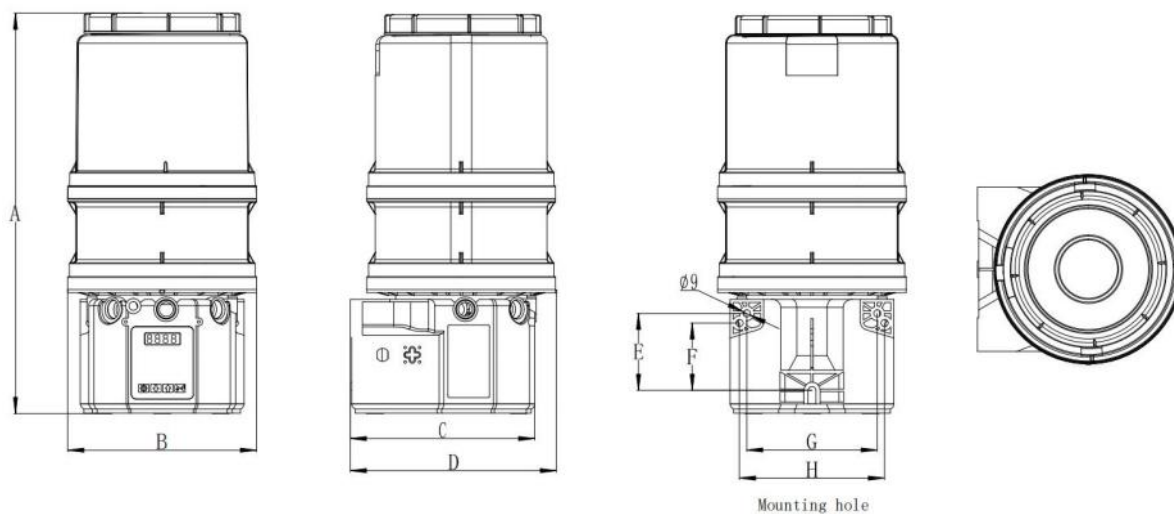

Reservoir	A	B	C	D	E	F	G	H
8L	498	235	231.5	255.5	95.5	83.5	162.5	180.5



GT Pump

Ordering information:

2. Every factory GT pump is equipped with a pump element at the T1 position. Customers can purchase pump element and install them in positions T2 through T5!

Only suitable for A6, if you choose other pump head, please consult customer service.

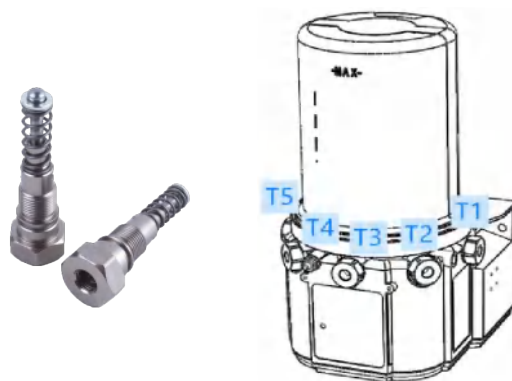

3. Displacement can be adjusted by shims. Pump displacement settings can use 0, 1 or 2 spacers. More than 2 spacers are prohibited.

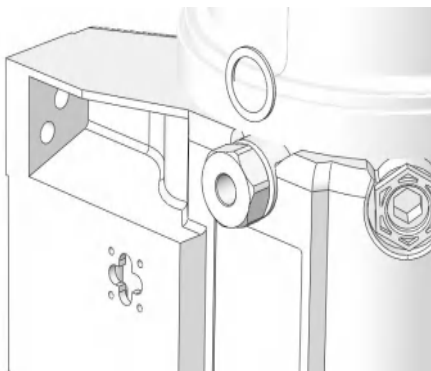

No. Spacers	Output Volume/Minute	
	cubic inches	cubic cm
2	0.12	2
1	0.18	3
0	0.25	4

Ordering code: 80535



Fill grease type:

① with grease gun kits



② with cartridge

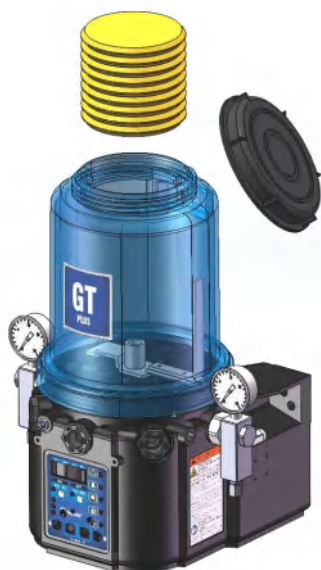

③ with hand pump



GT Pump

Ordering information:



20-

Type D = Stirrer E = With follower plate
Reservoir 2 = 2L 4 = 4L 6 = 6L 8 = 8L 12 = 12L
Voltages 2=12VDC 4=24VDC 6=220V
Timer 1 = With timer 6 = Without timer
Low Level L = With level M = Without level
Lubricant G = Grease O = Oil
Fill Type N = Rease Nipples F = Quick connection
Reservoir Feature A = Without top cover B = With top cover



Grease filling connector



GT Pumping Element





Part number	Description	Thread	Part number	OD	Rated flow
80220	Male connector	G1/4	80536	6mm	A6; 4ml/min
80221	Female connector	G1/4	80537	7mm	A7; 5ml/min

Pump outlet assembly

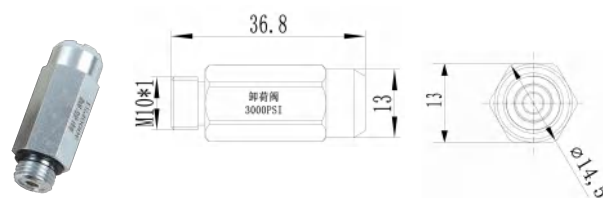

Safety valve

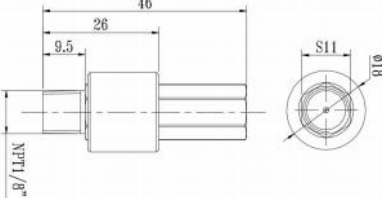

Part number	Description	Pressure	OD	Part number	Pressure	Male thread			
80532PG	With pressure gauge	100bar/ 1450psi	6mm	5FI05	207bar/3000psi	M10*1			
80532PG-8			8mm						
80532	Without pressure gauge		6mm				Safety valve		
80532-8			8mm						
80533PG	With pressure gauge	275bar/ 4000psi	6mm						
80533PG-8			8mm						
80533	Without pressure gauge		6mm			Part number	Description	Male thread	
80533-8			8mm			5FI07	275bar/4000psi	NPT1/8	



Accessories

Safety valve

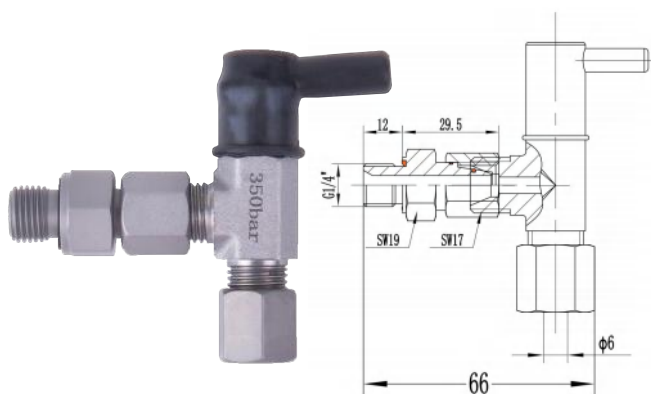

Controller shield



Part number	OD	Male thread	Pressure	Description	Part number
5FJ01	φ6	G1/4	345bar/5000psi	PC	97116

Follow plate ang grease gun kits :

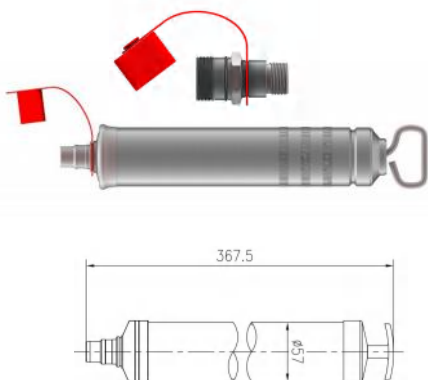

Description	Part number	Fitting
Grease Gun	MG500	-
Grease fitting assembly	MG500-A-GT	Grease fitting without check valve
Grease fitting assembly	MG500-C-GT	Grease fitting with check valve



Description	Part number	Oil drum
Follower Plate	95660C	16KG

GT Mounting bracket



Description	Part number
Mounting bracket	90236



Button with green lamp



Pressure switch

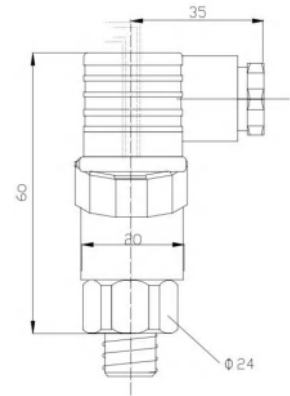

Description	Part number
12V	90212
24V	90224

Description	Part number
Adjustable Type	91346

Wiring diagram

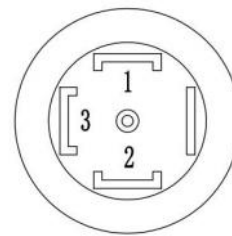

DIN plug

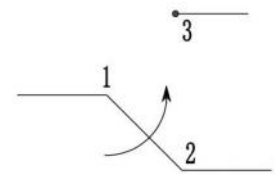

SPDT Normally open + normally closed

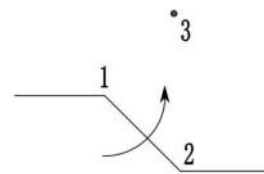

SPST Normally closed type

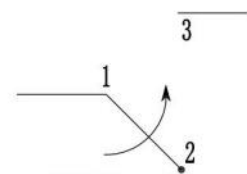

SPST Normally open type

Cartridge



Description	Part number	Reservoir
Cartridge	CSL-J100	700CC
	CSL-C100	700CC





GM PUMP

- More compact size
- Pump oil and grease
- Multiple grease filling ways
- Powerful centralized control system
- Multiple voltages are available

Small size, large performance

HIGH PERFORMANCE IN A COMPACT PUMP

GM is a piston pump, predisposed to operate with a maximum of five pumping units, Five independent line lubrication at the same time.

Output can be combined and increase displacement. Its design is particularly suitable for progressive systems or single line systems.

Its size is particularly suitable for installation in small Spaces.

With a maximum working pressure of 25Mpa, it is a more economical solution for lubrication systems.

The special body material achieves very excellent seismic function.

With special materials, to achieve excellent anti-shock ability Special design of pump make it easy to observe the oil level and prevent UV radiation, prevent oil deterioration.

With low liquid level alarm, flashing buzzer. Also can choose the type of output.

There are two model modes:

Standard: can be managed by an external PLC. Since it does not come with an internal control unit, this is the most economic solution for lubricating your systems.

Automatic: With integrated control system, which can be set up local running time. Equipped with local operation and alarm light, alarm with buzzer, provide low level and pulse alarm, which can be combined with the monitor of distributor units into a perfect operating system.



Characteristics

- Reservoir: 1.5L, 2L, 4L
- Voltages: 12VDC, 24VDC, 220VAC
- Pump oil and grease
- Multiple grease filling ways
- Powerful centralized control system
- CE Certification
- Design patent
- IP67

Application

- Construction machinery
- Agricultural equipment
- Wind power equipment
- Press machine
- Mining equipment
- Ship and Marine engineering
- Food and drinking
- Textile

.....



Control System

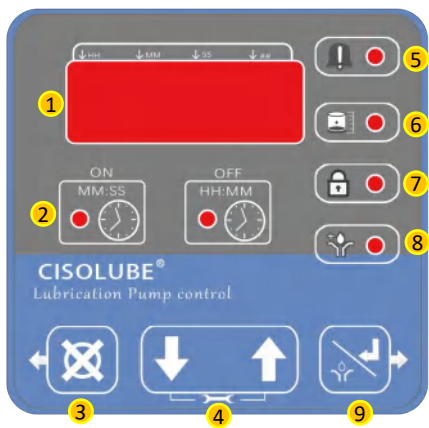

Basic function

- 1 Easy to read LED display
- 2 Legible on/off instructions
- 3 Reset function
- 4 Easy to use navigation keys
- 5 Alarm signal of lube system shutdown
- 6 Low level indication
- 9 Manually run/Confirm

Custom function

- 7 Access to the control device is password protected
- 8 Pre-lube capability

★ For additional customization features, please contact your sales manager.

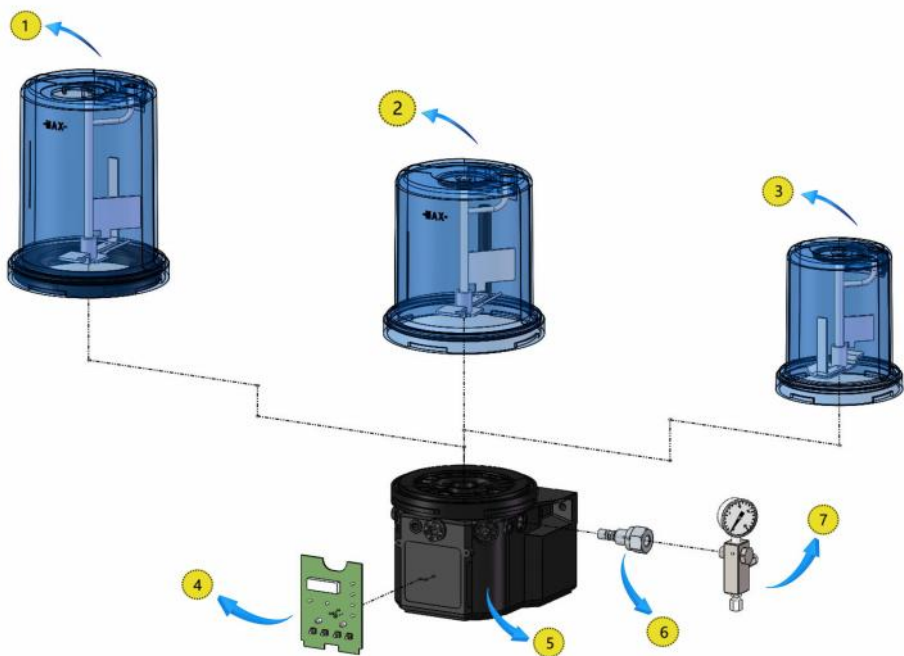

Nº	Part	Nº	Part
1	4L Pump Tank	5	Pump base
2	2L Pump Tank	6	GM Pumping Element
3	1.5L Pump Tank	7	Pump outlet assembly (With pressure gauge)
4	Control panel		



1.5L Dimensions (mm):

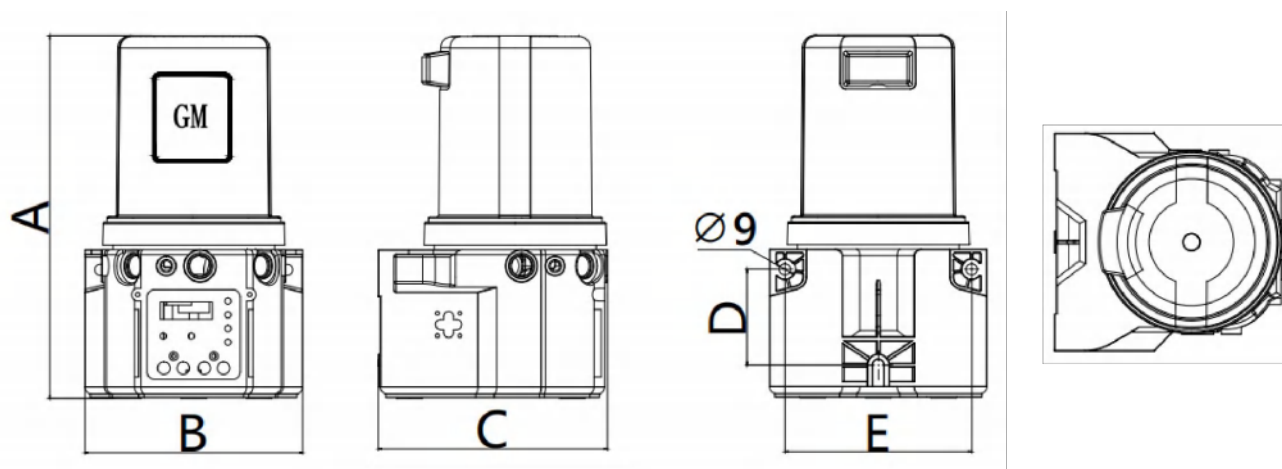

Reservoirs	A	B	C	D	E
1.5L	292	175	184	77	150

2L&4L Dimensions (mm):

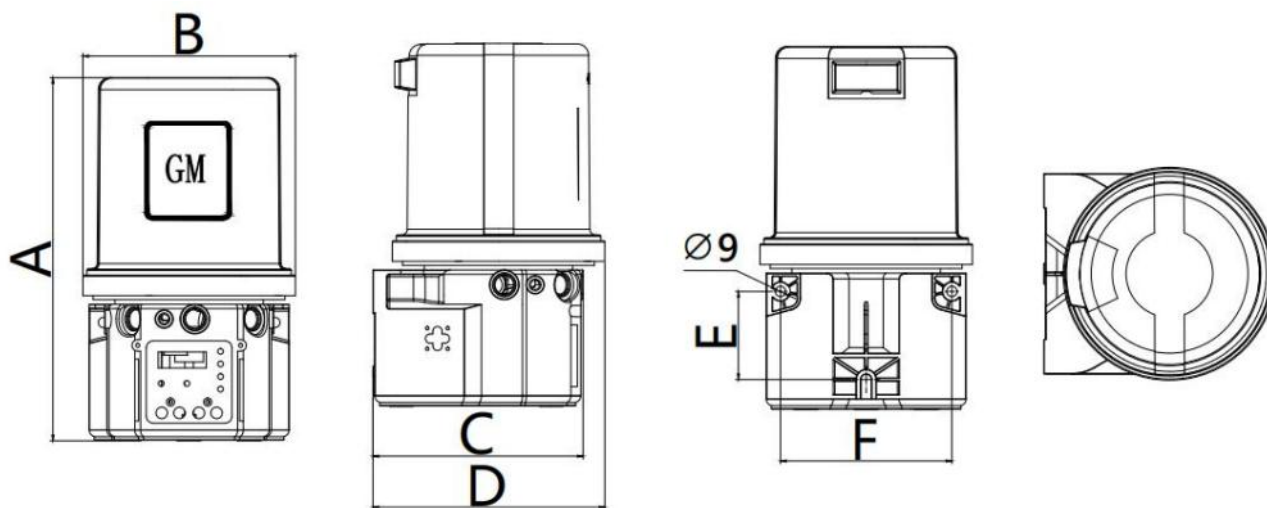

Reservoirs	A	B	C	D	E	F
2L	314	186	184	203	77	150
4L	354	186	184	203	77	150



GM Pump

Technical information:

Technical characteristics

Unit of pump outlets	Max. 5 outlets
Outlet thread	G1/4
Rated flow	4ml/min
Operating pressure	Max. 25MPa
Reservoir Capacity	1.5、 2、 4L
Lubricants	OIL、 000、 00、 0、 1、 2
Operating temperatures	-40 - 90°C



Ordering information:



22-

[illegible]

<p>Type</p> <p>D = Stir</p>
<p>Reservoir</p> <p>1 = 1.5L 2 = 2L</p> <p>4 = 4L 7= Cartridge</p>
<p>Voltages</p> <p>2 = 12VDC 4 = 24VDC</p> <p>3= AC110V 6 = 220VAC</p>
<p>Timer</p> <p>1 = with timer</p> <p>6 = without timer</p>
<p>Low Level</p> <p>L= with level</p> <p>M= without level</p>
<p>Lubricant</p> <p>G = Grease</p> <p>O = Oil</p>
<p>Fill Type</p> <p>N = Grease Nipples</p> <p>F = Quick connection</p>
<p>Reservoir Feature</p> <p>A = Without top cover</p> <p>B = With top cover</p>

GM Pump

Every factory GM pump is equipped with a pump element at the T1 position. Customers can purchase pump element and install them in positions T2 through T5!

Only suitable for P6, if you choose other pump head, please consult customer service.

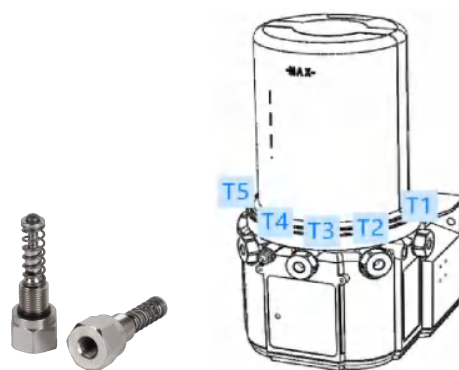

Grease filling connector



GM Pumping Element



Part number	Description	Thread	Part number	OD	Rated flow
80220	Male connector	G1/4	88535	5mm	P5; 3.3ml/min
80221	Female connector	G1/4	88536	6mm	P6; 4ml/min

Safety valve

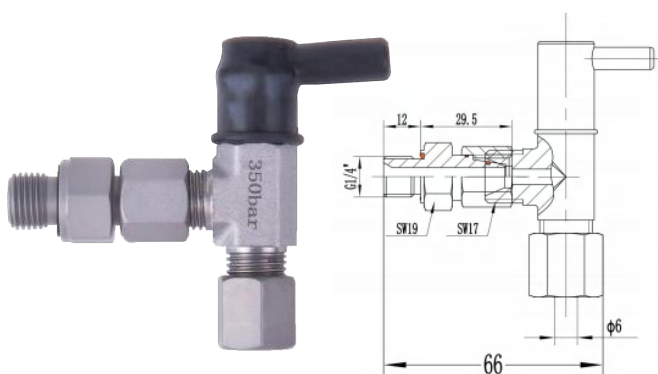

Controller shield



Part number	OD	Male thread	Pressure	Description	Part number
5FJ01	φ6	G1/4	345bar/5000psi	PC	97117



Safety valve

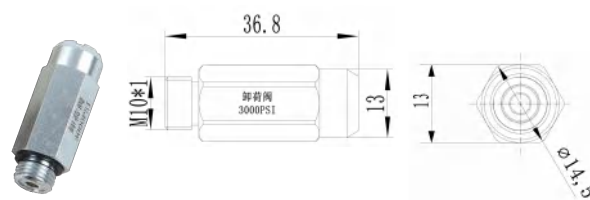

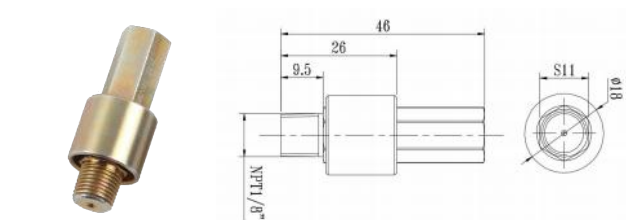
Part number	Description	Pressure	OD	Part number	Pressure	Male thread
80532PG	With pressure gauge	100bar/ 1450psi	6mm	5FI05	207bar/3000psi	M10*1
80532PG-8			8mm			
80532	Without pressure gauge		6mm			
80532-8			8mm			
80533PG	With pressure gauge	275bar/ 4000psi	6mm			
80533PG-8			8mm			
80533	Without pressure gauge		6mm			
80533-8			8mm			

Safety valve

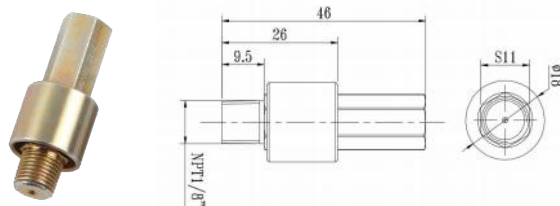

Part number	Description	Male thread
5FI07	275bar/4000psi	NPT1/8



Description	Part number	Thread
Grease Gun	MG500	-
Grease fitting assembly	MG500-A-GM	Grease fitting without check valve
Grease fitting assembly	MG500-C-GM	Grease fitting with check valve

Description	Part number	Oil drum
Follower Plate	95660C	16KG

GM Pump

GM Mounting bracket



Description	Part number
Mounting bracket	90235

Button with green lamp



Description	Part number
12V	90212
24V	90224

Cartridge



Description	Part number	Reservoir
Cartridge	CSL-J100	700CC
	CSL-C100	700CC

Pressure switch

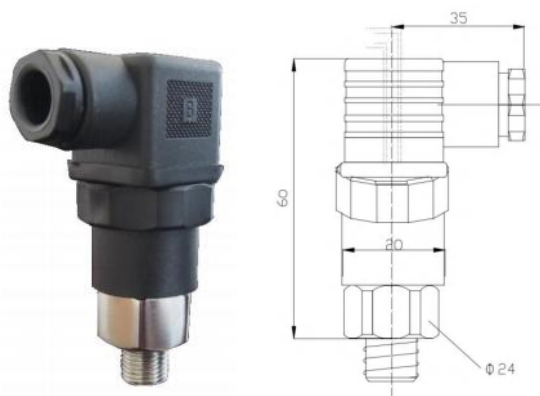

Description	Part number
Adjustable Type	91346

Wiring diagram

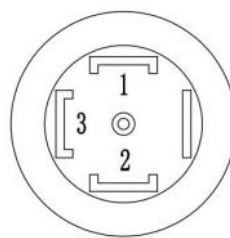

DIN plug

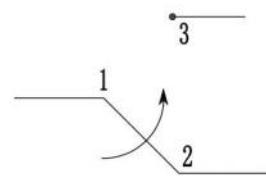

SPDT Normally open + normally closed

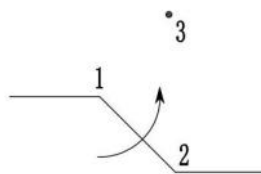

SPST Normally closed type

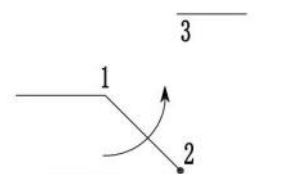

SPST Normally open type



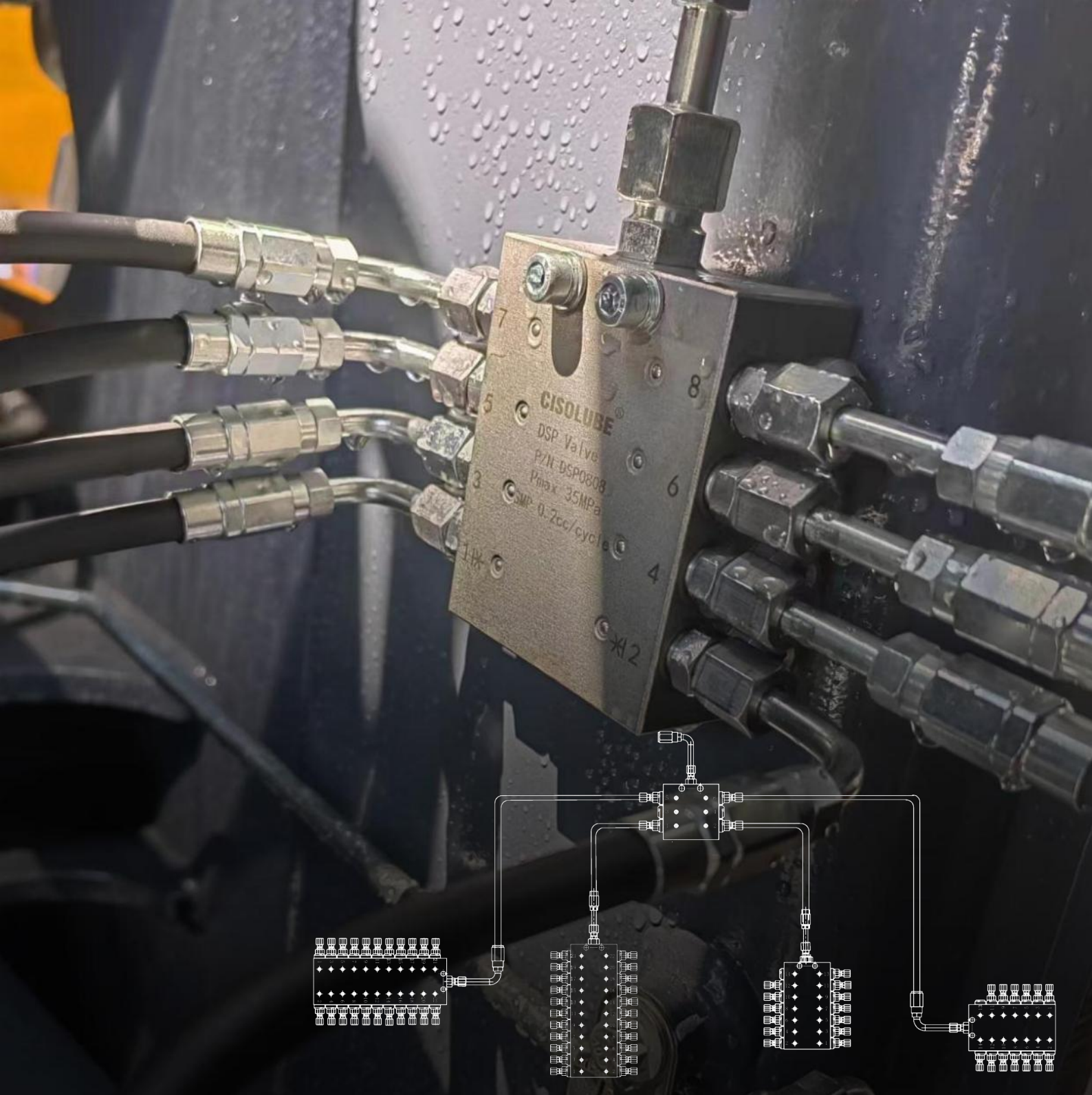

DSP Distributor

- Max. Pressure 35Mpa, 5000psi
- Sizes up to 22 outlets
- High operating pressure
- Unique internal crossporting technology
- Available in different materials

Single block progressive distributor valve

The DSP is a single block progressive divider valve that is ideal for applications where space is limited.

It is available in 6,8,10,12,18,20 and 22 outlet versions, each with an output of 0.2 cm³ inch per cycle.

An outlet can also be merged with the sequential outlet on the block by removing the special outlet fitting and installing a plug.

Visual or electronic monitoring can be achieved simply by removing a plug and installing a visual or electronic add-on device as shown below. The spools in a progressive metering valve operate sequentially partitioning equally across the outlets, the grease being pumped into the metering block inlet.

The grease pumped inside of the block is distributed by the piston dispensers of the progressive dosing device equally among the different outputs. In case a single output becomes blocked, the pistons stop their activity allowing for the control of the entire system by means of a single device for this purpose.



Characteristics

- Sizes up to 22 outlets
- High operating pressure
- Available in different materials
- Exact lubricant metering
- Unique internal crossporting technology
- Optionally equipped with visual monitoring pin or with electrically monitored piston detector

Applications

- Construction and mining
- Farm machinery
- Industrial equipment
- Renewable energies
-



Dimensions(mm) :

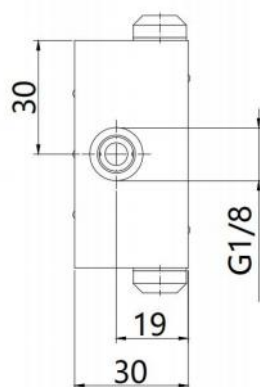
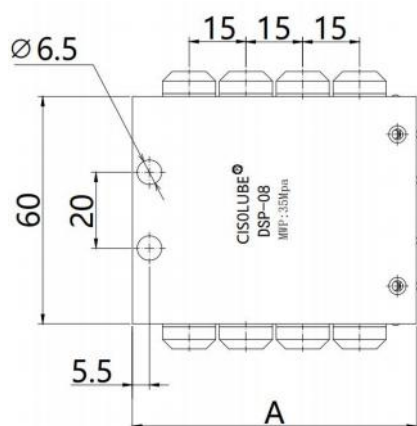

Outlets number	A
6	60
8	75
10	90
12	105
14	120
16	135
18	150
20	165
22	180

Product feature:

Technical parameters

Min. Pressure	Min. 20 Bar
Max. Pressure	Max. 350 Bar
Lubricants	Oil 46 - NLGI-2#
Operating temperature	-40 °C to 200 °C
Discharge (for outlet)	0.2ml/cyc
Inlet thread	G1/8
Outlet thread	M10x1
Outlets number	6 - 22
Piston cycles	Max 200 cyc/min
Material	Carbon steel or SS

Outlets can be combined, Outlet * 1 and * 2 should never be closed.



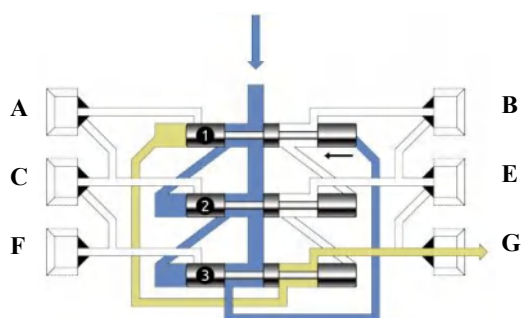

1

Lubricant flow pressure (blue) moves piston 1 to the left allowing lubricant discharge (yellow) from G.

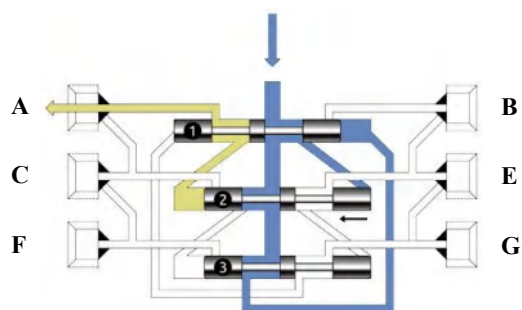

2

When piston 1 reaches its limit, lubricant flow pressure (blue) operates on piston 2. Lubricant volume (yellow) discharge from A.

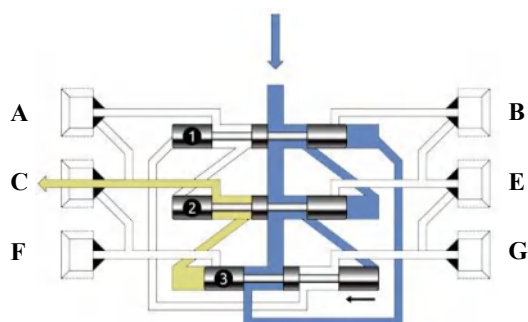

3

When piston 2 reaches its limit, lubricant flow pressure (blue) operates on piston 3. Lubricant volume (yellow) discharge from C.

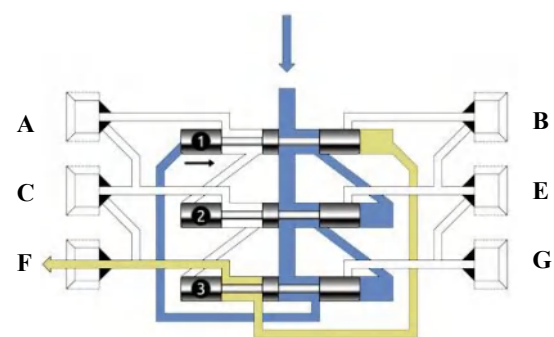

4

When piston 3 reaches its limit, lubricant flow pressure (blue) operates on piston 1. Lubricant volume (yellow) discharge from F.

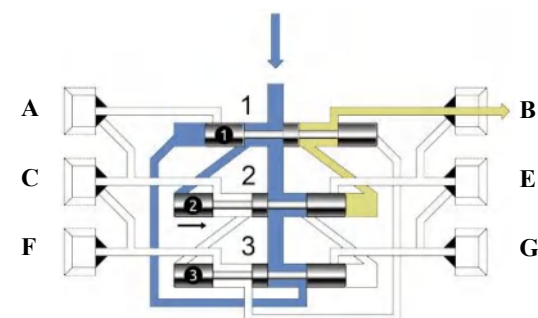

5

When piston 1 reaches its limit, lubricant flow pressure (blue) operates on piston 2. Lubricant volume (yellow) discharge from B.



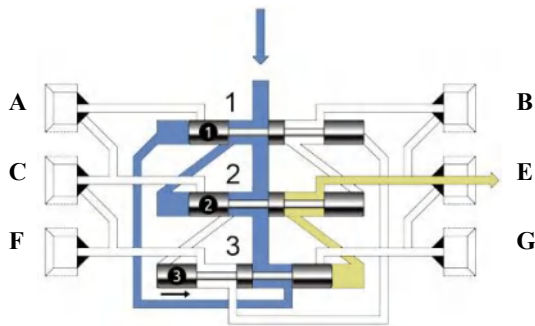

6

When piston 2 reaches its limit, lubricant low pressure (blue) operates on piston 3. Lubricant volume (yellow) discharge from E. The system is ready for a new cycle.

Visual pin:



The visual pin shows the piston movement, monitoring the proper operation of the entire system.

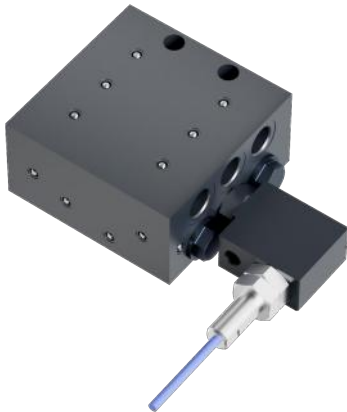

Inductive sensor:

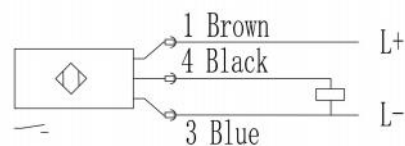
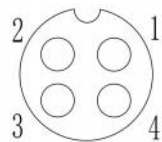

Voltage	10-30 VDC
Outlet current	Max 200 mA
Operating temperature	- 25 °C to +70 °C
Discharge (for outlet)	0.2ml/cycle
Sensor block	Pet-G
Connection	M8x1



Ordering Number Without inlet and outlet fittings:

Standard	Outlets number	Part number
	6	31N03
	8	31N04
	10	31N05
	12	31N06
	14	31N07
	16	31N08
	18	31N09
	20	31N10
With visual pin	Outlets number	Part number
	6	33V03
	8	33V04
	10	33V05
	12	33V06
	14	33V07
	16	33V08
	18	33V09
	20	33V10
With inductive sensor	Outlets number	Part number
	6	33M03
	8	33M04
	10	33M05
	12	33M06
	14	33M07
	16	33M08
	18	33M09
	20	33M10



Ordering information:

	DSP-	<input type="checkbox"/>	<input type="checkbox"/>	<input type="checkbox"/>	<input type="checkbox"/>	<input type="checkbox"/>	<input type="checkbox"/>	<input type="checkbox"/>
A = Zinc-nickel B= Zinc-nickel black								
Outlet Number 06=6 08=8 10=10 ⋮ 22=22								
Inlet Connector XX= Without inlet fittings 06=Ø6mm 08=Ø8mm								
Inlet Connector shape D= Straight fitting assembly H= 90° fitting assembly								
Type XXX= without pin Visual Pin Cxx = Install the outlet in xx Inductive sensor Exx =PNP Install the outlet in xx Ultra sensor KRxx = Install the outlet in xx								
Plug XD=3-20								
Outlet Connector XX= Without outlet fittings S6= Ø6mm Fitting with check valve K6= Ø6mm Quick Fitting								



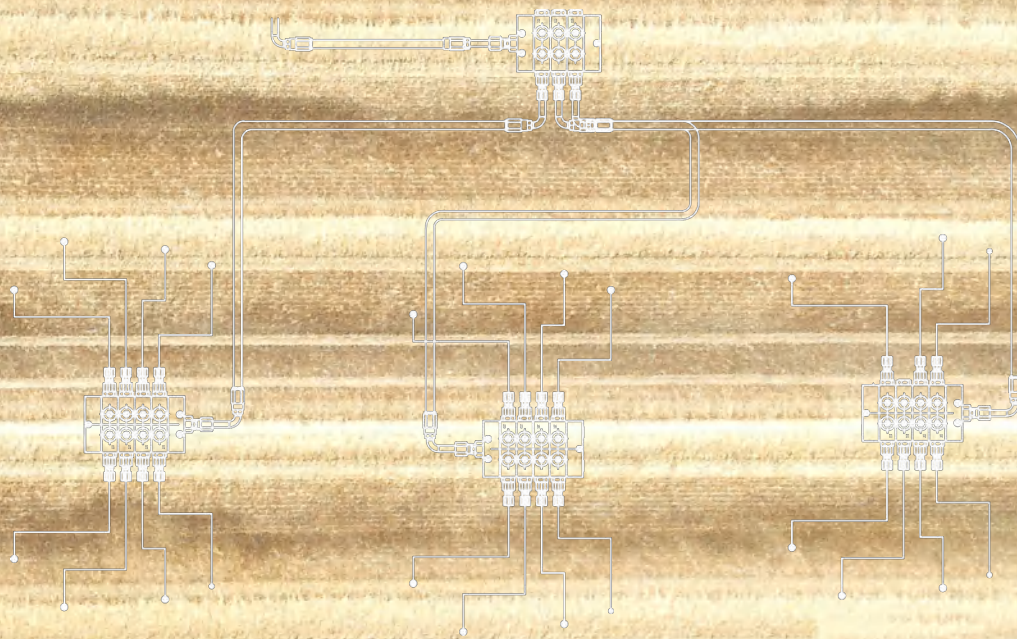

VB VALVE

Maximum Operating Pressure - 30Mpa,
4200psi

For the progressive delivery of mineral oil
and grease for lubrication.

For Professional Use Only.

Metering elements for progressive distributor of oil and grease

A typical VB distributor valve consists of a "first piece", a "tail piece" and 3 to 10 working pieces. Can provide 3 to 20 lubrication points of lubrication, VB distributor valve working piece, a variety of specifications of displacement for selection. The double outlet working piece (after the specification value of the working piece, the T represents the double outlet) has two oil outlets, which can be set as the side or upper output; the single outlet (after the specification value of the working piece, the S represents the single outlet) has one oil outlet, which can be at either end of the working piece, and the other end needs to be blocked. Note: that the double outlet working piece should not block any outlet, otherwise it will affect the normal operation.



Magnetic and electronic proximity switch cycle indicators can be easily configured to provide positive protection for successful lubrication

Characteristics

- Volumetric flow of up to 0.08ml~0.64ml/cyc
- Universal use in continuous or intermittent operation
- Metering sections with variable metering amount
- Internal and external consolidation of outlets
- Visual or electrical monitoring op

Applications

- Construction and mining
- Farm machinery
- Industrial equipment
- Renewable energies
-



Product composition:

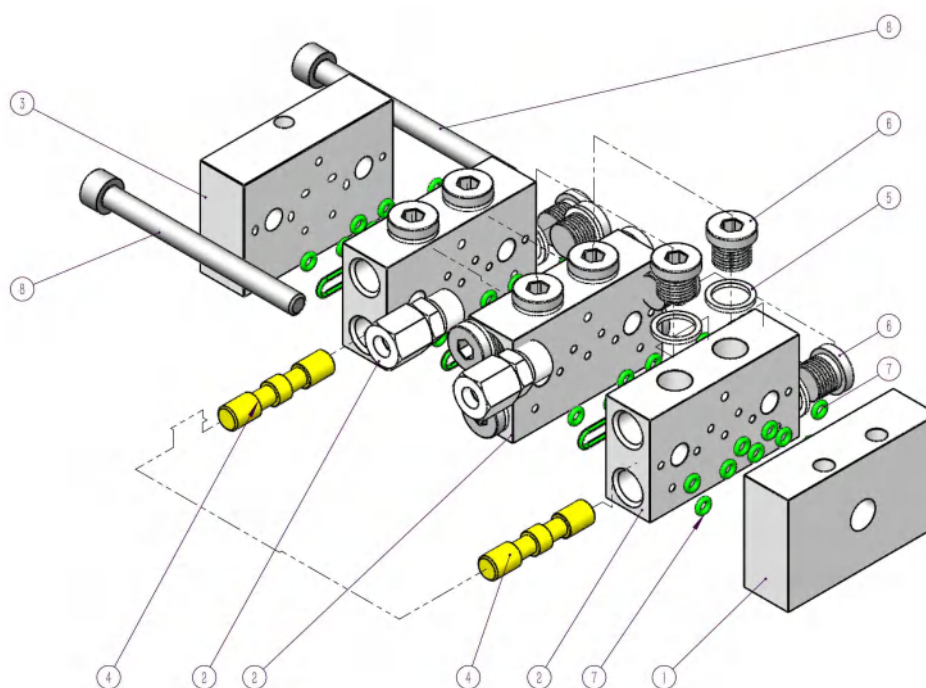

1 — First element

5 — Gasket

2 — Divider element

6 — Plug

3 — Tail element

7 — O-ring:FKM(-20°C~200°C) /NBR(-40°C~110°C)

4 — Plunger

8 — Bolt

Technical parameters

Operating pressure	Max 30Mpa
Lubricants	Oil 46 to Grease NLGI-2
Operating temperature	-40 °C to 110 °C
Inlet thread	R1/8
Outlet thread	M10x1
Outlets number	Max. 20
Coating	Zinc-Nickel plated



Structure and working principle

Lubricant pressurization: by pump

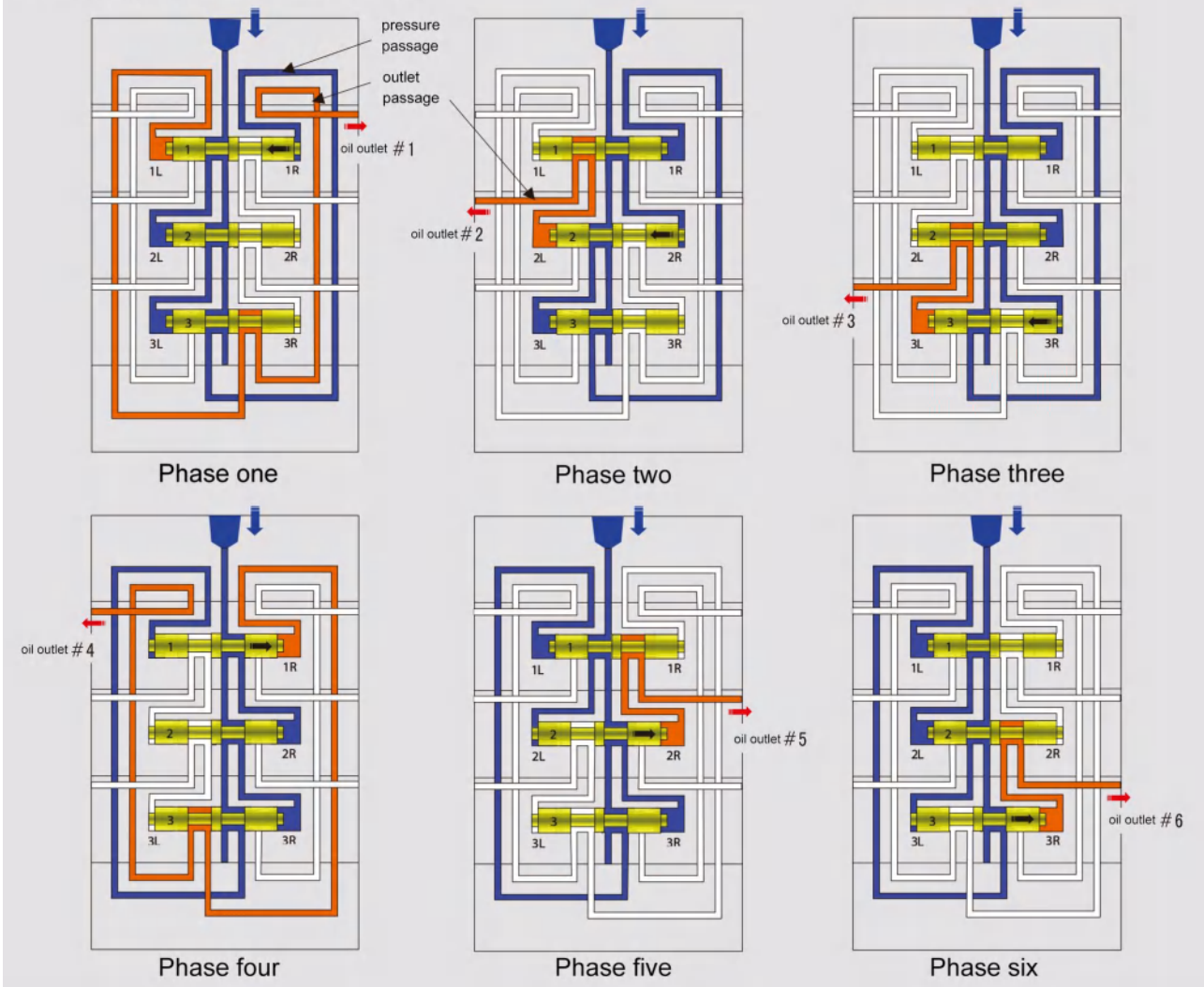

The pumped lubricant is pressed into the distributor through the first oil inlet.

First assume that the 3 plungers of the valve body are all located on the right side, and the inflowing lubricant will enter the 1R, 2L, 3L sides of the valve chamber.

Stage One

The lubricant flowing into the valve chamber 1R pushes the plunger 1 to the left end, and the plungers 2 and 3 are fixed. The plunger 1 moves from right to left, while the lubricant in the 1L valve chamber flows along the oil outlet from the oil #1 squirting.

Stage Two

When the plunger 1 moves to the left end and stops, the lubricant pressure of the push plunger 1 is transferred to the valve chamber 2R side, the push plunger 2 moves from the right to the left, and the lubricant at 2L is sprayed from the oil outlet #2

Stage Three

When the plunger 2 stops at the left end, the pressure drop of the lubricant in the push plunger 2 is transferred to the valve chamber 3R side, the push plunger 3 moves from the right to the left, and the lubricant located in the valve chamber 3 is ejected from the oil outlet #3. When plunger 3 stops at the left end, all plungers will be on the left.

Stage Four ~
Stage Six

Then start from the plunger 1 and push it from the left to the right, the lubricants in the valve chambers 1R, 2R, 3R are sprayed from the oil outlets #4, #5, #6.

The above process of stages 1-6 is repeated as the lubricant continues to be delivered to the dispenser.



VB distributor

Dimensions

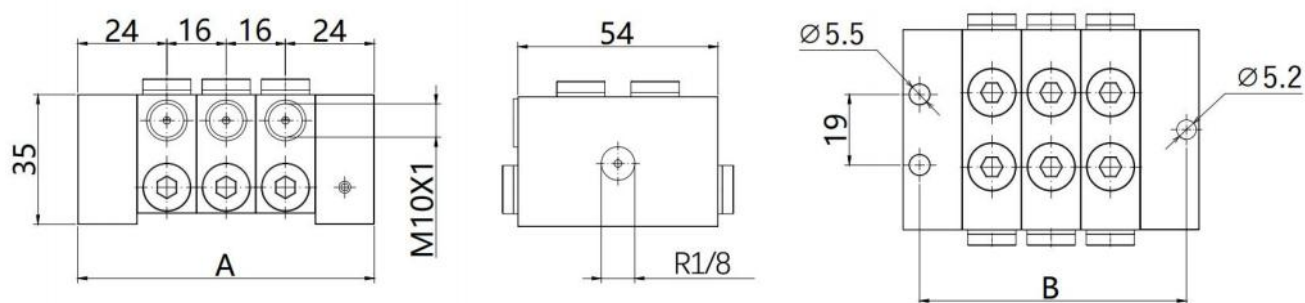

Number of work	A(mm)	B(mm)	Number of work	A(mm)	B(mm)
3	80	72	7	144	136
4	96	88	8	160	152
5	112	104	9	176	168
6	128	120	10	192	184

Notes: A and B in the above table are theoretical values, which may have errors with real objects due to the influence of cumulative assembly errors of distributors.

Elements specification	Discharge (for outlet) (ml/cyc)	Max. Pressure	Min. Pressure	Number of oil outlets per piece
VB-05S	0.16	30Mpa	1.4Mpa	1
VB-05T	0.08	30Mpa	1.4Mpa	2
VB-10S	0.32	30Mpa	1.4Mpa	1
VB-10T	0.16	30Mpa	1.4Mpa	2
VB-15S	0.48	30Mpa	1.4Mpa	1
VB-15T	0.24	30Mpa	1.4Mpa	2
VB-20S	0.64	30Mpa	1.4Mpa	1
VB-20T	0.32	30Mpa	1.4Mpa	2



Ordering information

Element Number 3-10	VB-	<input type="text"/>	<input type="text"/>	<input type="text"/>	<input type="text"/>
Inlet fitting shape X= Without inlet fitting D= Straight fitting assembly H= 90° fitting assembly					
Inlet fitting 6=Ø6 8=Ø8					
Flow rate (ml) 05= 0.08 10= 0.16 15= 0.23 20= 0.32					
Outlets T= Double outlet SL= Left single outlet SR= Right single outlet					
Visual Pin VR= Visual pin right VL= Visual pin left Inductive sensor ER=PNP Mounted on the right EL= PNP Mounted on the left Ultra sensor KRR= Mounted on the right KRL= Mounted on the left					
Safety valve M10= 10Mpa Safety valve M20= 20Mpa Safety valve					
Outlet fitting S6= Ø6mm Fitting with check valve Q6= Ø6mm Push-in fitting					



Ordering instructions:

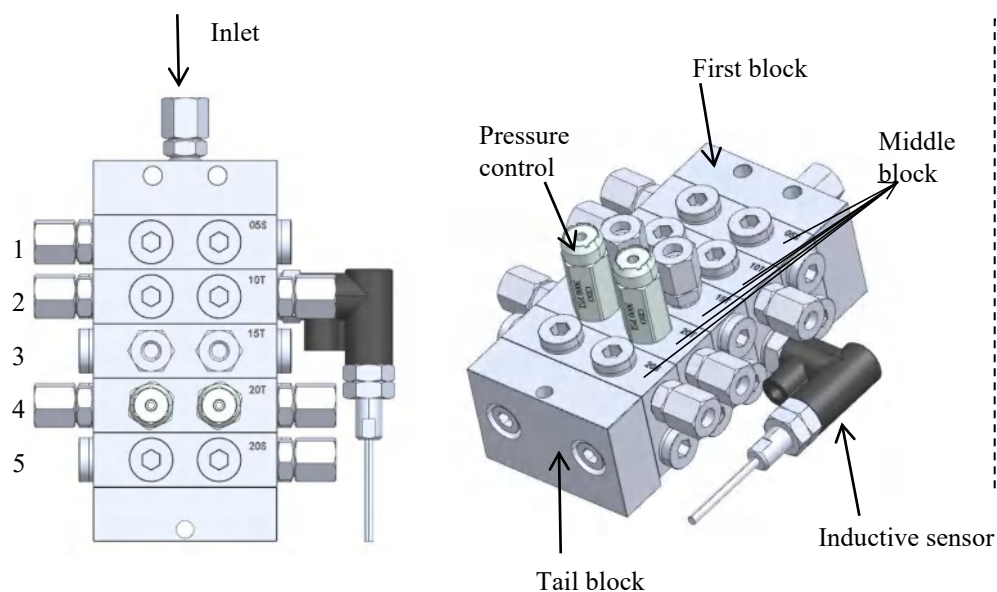

Flow rate (ml)	Outlets	Cycle control	Pressure control			Outlet fittings
			Type	Pressure (Mpa)	Location	
05	T Double outlet	ER PNP Inductive sensor Right	M Safety valve	10	L Left	Q4 Ø4 Push-in straight
10	SL Single left	EL PNP Inductive sensor Left		20	R Right	Q49 Ø4 Push-in 90°
15	SR Single right	VR Visual pin right			LR Left/Right	D4 Ø4 Straight fittings
20	BL Bridge left	VL Visual pin left			UL Single left upper	D49 Ø4 90° fittings
	BR Bridge right	KRR Ultra sensor right			UR Single right upper	Q6 Ø6 Push-in straight
	BLR Bridge left&right	KRL Ultra sensor left			ULR Single left&right upper	Q69 Ø6 Push-in 90°
	U Both upper					S6 Ø6 Straight fitting with check valve
	UL Single left upper					D69 Ø6 90° fittings
	UR Single right upper					

Order example: VB-5-D6 05SL S6 /10T ER S6/15T U S6/20T M20ULR S6/ 20SR S6

1

2

3

4

5



Inlet fittings:

Straight fitting assembly

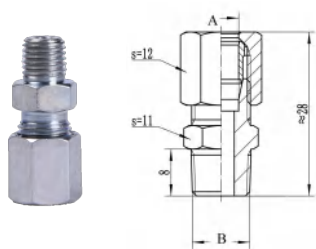

90° fitting assembly

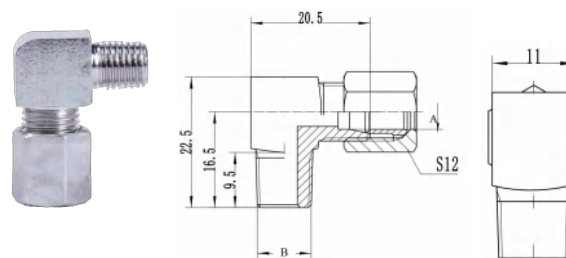

Part number	A	B	Material	Part number	A	B	Material
5DM0802	Ø8	R1/8	Nickel plated	5HM0802	Ø8	R1/8	Nickel plated
5DM0602	Ø6	R1/8		5HM0602	Ø6	R1/8	
5DM0402	Ø4	R1/8		5HM0402	Ø4	R1/8	

Outlet fittings:

Straight fitting assembly

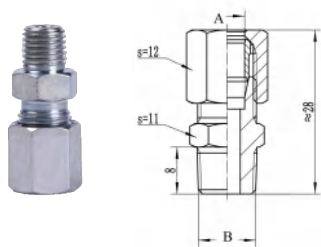

Angle fitting assembly

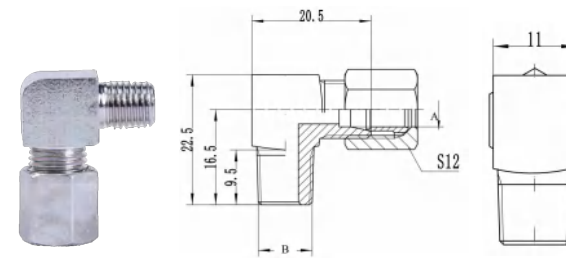

Part number	A	B	Material	Part number	A	B	Material
5DM0410	Ø4	M10*1	Nickel plated	5HM0410	Ø4	M10*1	Nickel plated
5DM0610	Ø6	M10*1		5HM0610	Ø6	M10*1	



VB distributor

Straight fitting with check valve

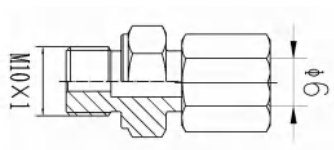

Outlet plug



Part number	OD	Thread	Material
5VM0610	Ø6	M10*1	Zinc plated

Part number	Thread	Material
5PC10	M10*1	Zinc plated

Adjustable fitting



With grease nipple inlet assembly:

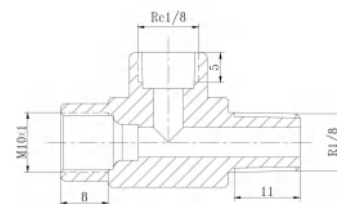

Part number	OD	Thread M	Material
5B0610	Ø6	M10*1	Nickel plated

Part number	Thread F	Thread F	Thread M
3T1002	M10x1	R1/8	R1/8



VSD distributor block



Manual Grease lubrication system components

VSD distributor block:

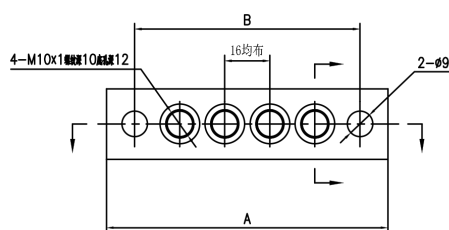
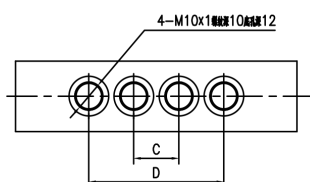

Specifications and parameters

Part Number	Out Thread	Out Number	A	B	C	D
VSD-04KT	M10*1	4	100	80	16	48
VSD-09KT	M10*1	9	180	128	16	48
VSD-12KT	M10*1	12	228	208	16	48

Can be customized according to customer requirements non-standard VSD distribution block, can also integrate Grease nipples and Push-in fitting, Flexible pipe. Contact your sales manager for details.

Straight Push-in fitting

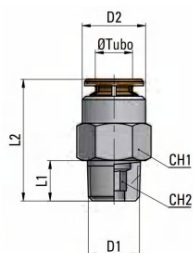

Straight fitting assembly

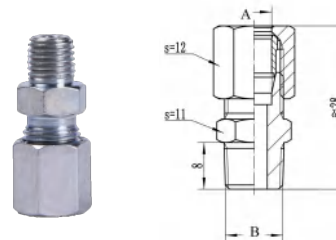

Part Number	OD	D1	D2	L1	L2
MP1104M10	Ø4	M10*1.0	9	8	20
MP1106M10	Ø6	M10*1.0	12	8	22

Part Number	A	B	Material
5DM0410	Ø4	M10*1	Carbon steel
5DM0610	Ø6	M10*1	Carbon steel

Grease Nipples



Part Number	Thread	Material
3NP10	ZM10*1	Nickel-plated



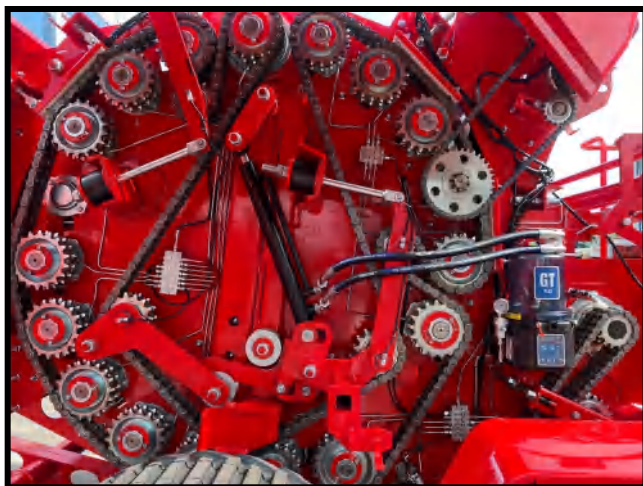

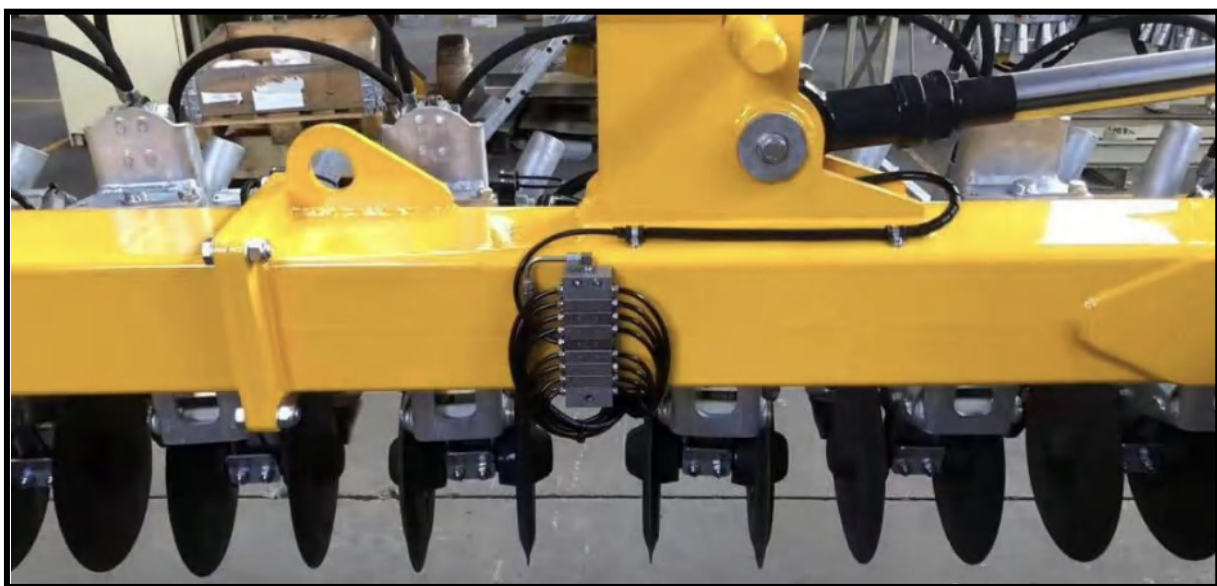
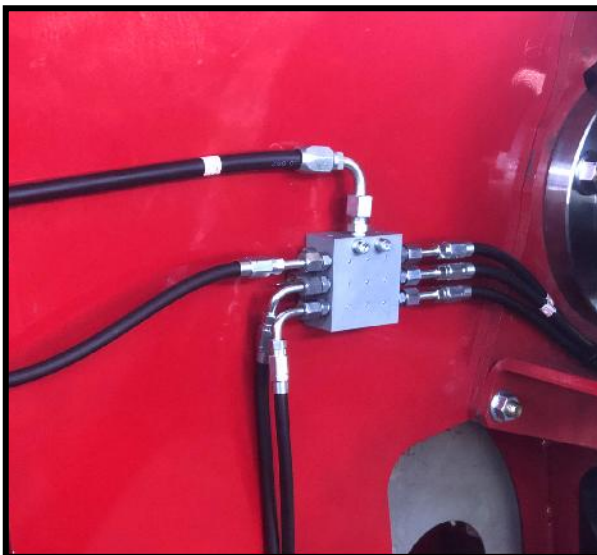
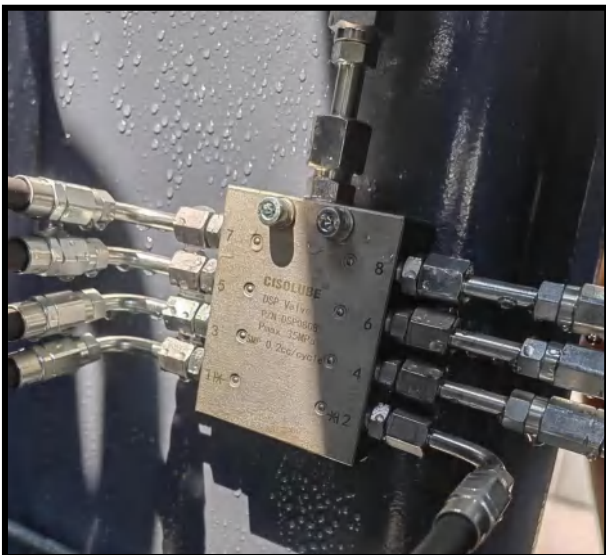



Chain lubrication systems

The system can be used for products with chain drive such as harvesters, balers, harvesters and mowers. Good lubrication can slow the impact, reduce friction, extend the service life of the chain.

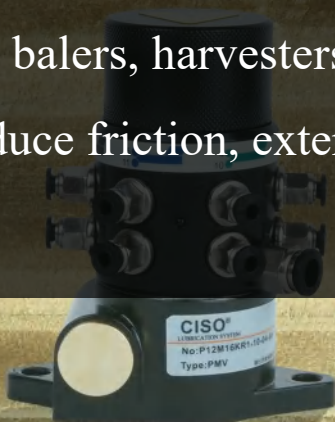

The main components of the system

- Compact structure and easy expansion
- No need for a distributor
- The pipes are smooth and have no residue
- Multiline output
- Adjustable displacement

PMV pump



- Plunger structure
- Single wire installation
- Solid pump body
- High performance cost ratio
- Flow stability

PMM pump



- Plunger structure
- Solid pump body
- No motor and controller required
- Equipped with inlet and outlet check valve
- High performance cost ratio
- Adjustable displacement

PMN pump



THE SYSTEM FOR AGRICULTURAL MACHINERY CHAIN

PMV is a multi-point piston pump operated by a cam system and designed to feed several independent lines up to a maximum of 12 outlets.



Characterised for its robustness and reliability, it is particularly suitable for lubricating systems installed in difficult environments.

The pump is designed to supply single-point lubrication systems in agricultural machinery and various kinds of machinery for use with oil.

The "PMV" pump is designed to operate with a maximum of six pistons, which are easily adjustable on 12 outlets.

The pump is designed for merging outlets (to be defined during the order phase); the same will be provided directly to the merged outlets according to your specifications. Merging the two outlets will allow for the nominal flow rate of a single outlet to be doubled.

Advantage

- Improve machine reliability
- Significantly reduce maintenance costs
- Economizing lubricant
- The reservoir can be placed within 0.5 m above or below the pump
- The PMV pump can operate for up to 1000 hours without oil and will not get stuck without refueling.
- Single-piston flow regulation is simple and fast
- The piston and flow are regulated parallel to the outlet
- The PMV pump is reversible, which means that its direction of rotation is not affected by mechanically driven steering

Characteristics

- | | |
|---------------------------|---|
| - 6-12 Outlets | - Flow rate is easy to adjust |
| - AVP Piston | - The pump has been tested for 1000 hours of lubricant-free operation |
| - Material: Aluminum base | - Suitable for harsh environments |



PMV multi-line chain lubrication pump

Technical Data

Inlet	Ø8、Ø10
Reservoir	4L、7L
Suction height	≤500mm
Filter Rate	20µm
Output	Ø 4
Ratio	7.6: 1 11.5: 1 25: 1 50: 1
Operating pressure	Max 10Bar
Output rate	Max 0.06cc/cyc
Viscosity range	25-1500cst

Struture diagram

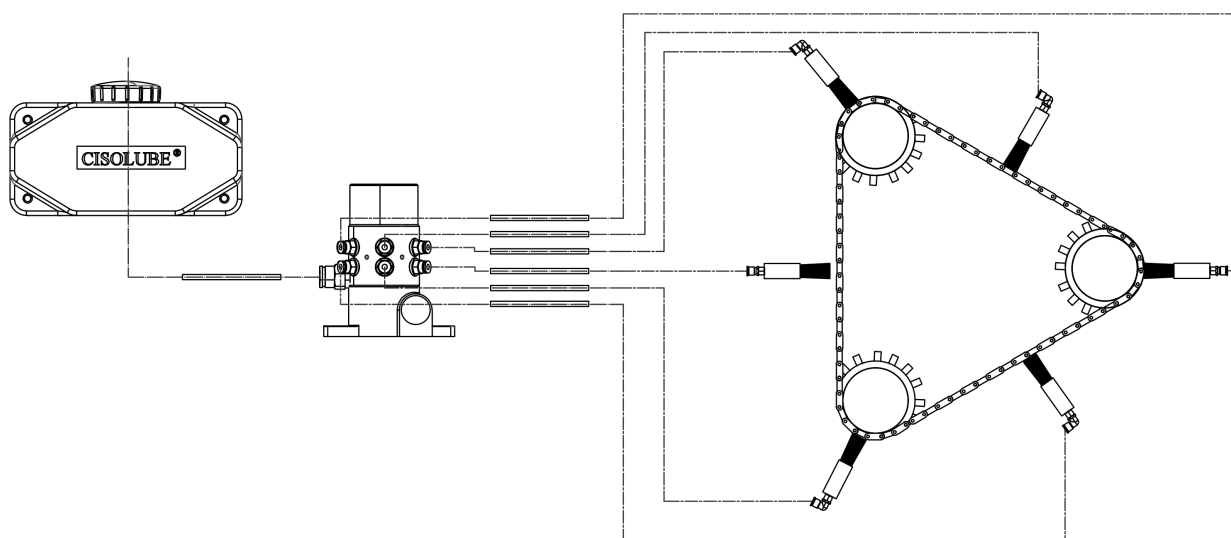

Dimensions (mm)

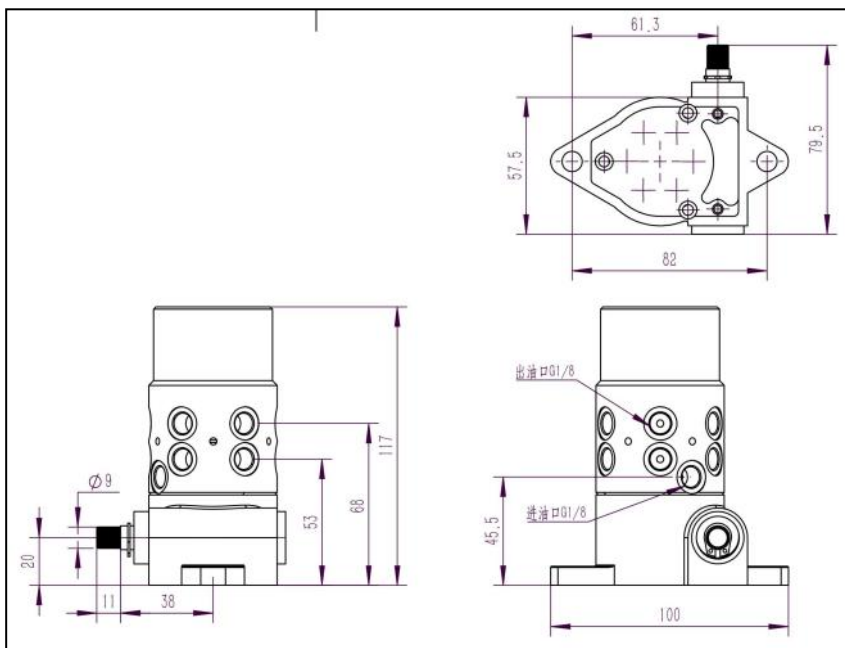

PMV pump

4L Reservoir with filter

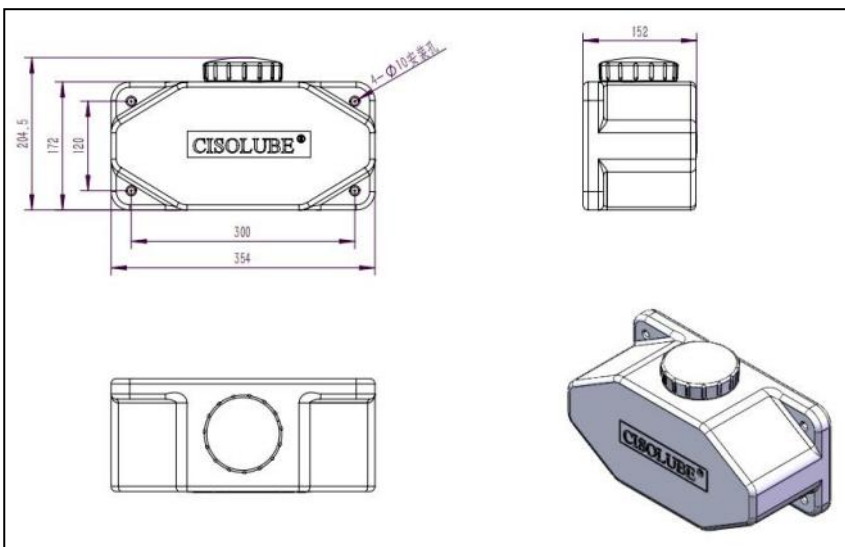
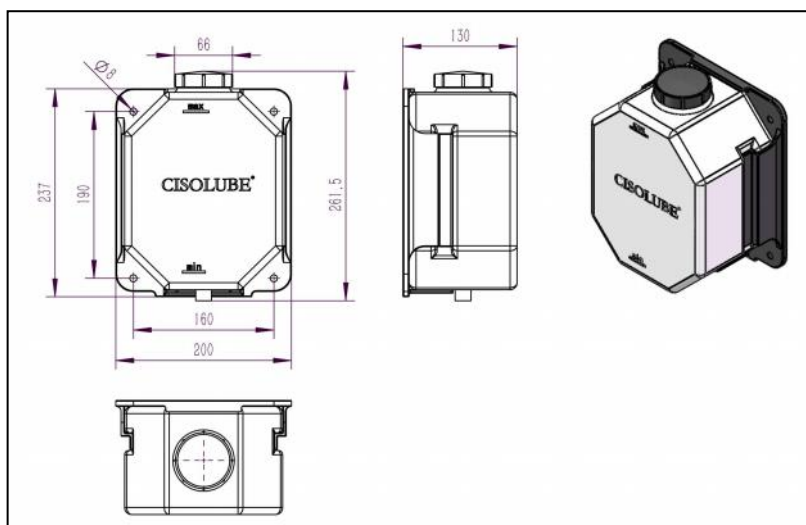

7L Reservoir with filter



PMV multi-line chain lubrication pump

Displacement adjustment

The displacement of the outlet can be adjusted with a screwdriver, and the use of electric tools is prohibited

No exit can be closed! The outlet that is not used must have the displacement adjusted to 0 and use a special plug.

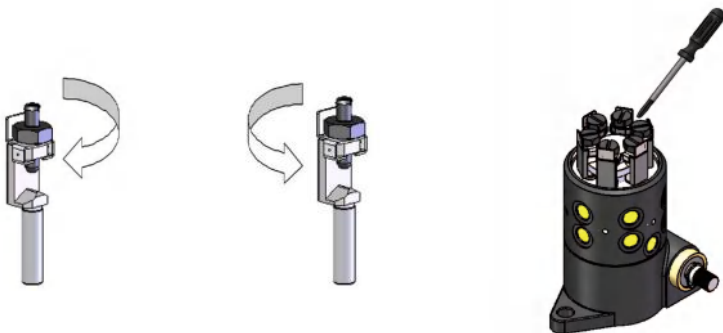

Please adjust after shutdown



Justification range

Frequency	Displacement $\pm 10\%$
0	60 mm ³ / stroke
1	57 mm ³ / stroke
2	53 mm ³ / stroke
3	50 mm ³ / stroke
4	47 mm ³ / stroke
5	44 mm ³ / stroke
6	41 mm ³ / stroke
7	37 mm ³ / stroke
8	34 mm ³ / stroke
9	31 mm ³ / stroke
10	27 mm ³ / stroke
11	24 mm ³ / stroke
12	21 mm ³ / stroke
13	17 mm ³ / stroke
14	14 mm ³ / stroke
15	11 mm ³ / stroke
16	8 mm ³ / stroke
17	4 mm ³ / stroke



PMV pump



P.N	Inlet OD	Ratio
P12M10076	Ø10	7.6 : 1
P12M08076	Ø8	7.6 : 1
P12M10115	Ø10	11.5:1
P12M08115	Ø8	11.5:1
P12M10025	Ø10	25:1
P12M08025	Ø8	25:1
P12M10050	Ø10	50:1
P12M08050	Ø8	50:1

Reservoir 4L



P.N	Technical specifications
RV08E04	Outlet OD 8mm; With filter
RV10E04	Outlet OD10mm; With filter

Reservoir 7L



P.N	Technical specifications
RV08E07	Outlet OD 8mm; With filter
RV10E07	Outlet OD10mm; With filter

Elbow Fitting, male 2Mpa

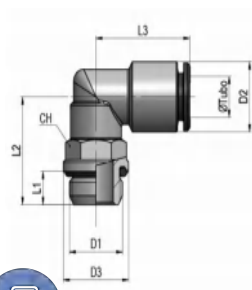

P.N	OD	D1	D2	L1	L2	Usage
AP160418	Ø4	G1/8	9	7.5	20	Pump outlet, brush



Order Information

Straight Push-in fitting , male 2Mpa

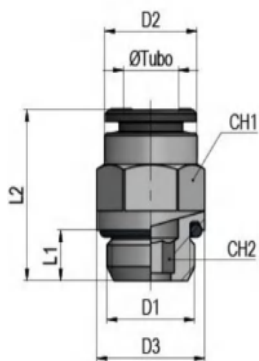

P.N	OD	D1	D2	L1	L2	Usage
AP120814	Ø8	G1/4	12	8	25.5	Reservoir outlet
AP121014	Ø10	G1/4	12	8	25.5	Reservoir outlet
AP120418	Ø4	G1/8	9	7.5	18.5	Pump outlet, brush
AP120818	Ø8	G1/8	9	8	20	Pump inlet
AP121018	Ø10	G1/8	12	8	25.5	Pump inlet

Tee Fitting

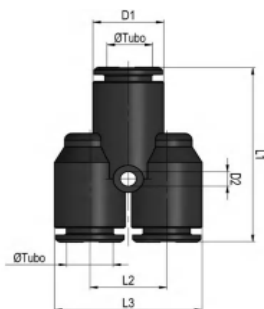

P.N	OD	D1	D2	L1	L2	L3
AP290404	Ø4	10	3.13	31.5	10	19.5

Brushes

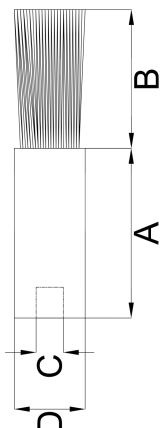

P.N	A	B	C	D	Material
MS-B01	55	44.8	G1/8	15	NYLON
MS-B02	55	44.8	G1/8	23	NYLON



Characteristics

- Dosing elements are required
- Material: steel
- Sturdy construction
- Adjustable displacement
- The pump has been tested for 1000 hours without lubricant
- Suitable for harsh environments

Application

- Bundling machine
- Combine harvester
- Pickup machine
- Field mower
- Fertilizer applicator

Adjustable automatic oil lubrication for bearings, chains & sprockets. Purpose designed for agricultural field equipment.

For agricultural field equipment and harsh environment, the system is concise, durable, unique and simple design makes it has the characteristics of stable performance and simple operation.

The PMM is a highly cost-effective chain lubrication system.

It is characterized by a strong structure, reliable use, especially suitable for the lubrication system installed in the harsh environment.

The pump is designed to supply dilute oil to single point lubrication equipment for agricultural vehicles and various machinery.

The PMM is a mechanically driven pump powered by the rotating shaft of farm equipment. With a unique cam patent design, 8 gears can adjust the output frequency of the pump, so as to achieve the purpose of adjusting the displacement. It is necessary to form a complete chain lubrication system with the main line, metering components and subpipelines.

Advantage

- A choice of reservoirs supply filtered oil to the pump.
- No motor and controller required, synchronized with the chain
- Significantly reduce maintenance costs
- Pump operated by adjustable cam or reciprocal machine cycle.
- Metered lubrication of each area as required
- Easily adjustable overall output to suit varying operating conditions via unique adjustable cam offering a choice of 8 preset outputs.
- Protected nylon brushes ensure a reliable and accurate feed of oil onto the chains ensuring pins are well lubricated.
- The pump is extremely robust and suitable for use in harsh environments
- A single system oils bearings and chains of any size in any combination.
- Helps keep chains oiled above the level where dust collects and grinding paste can form.



PMM multi-line chain lubrication pump

Dimensions(mm)

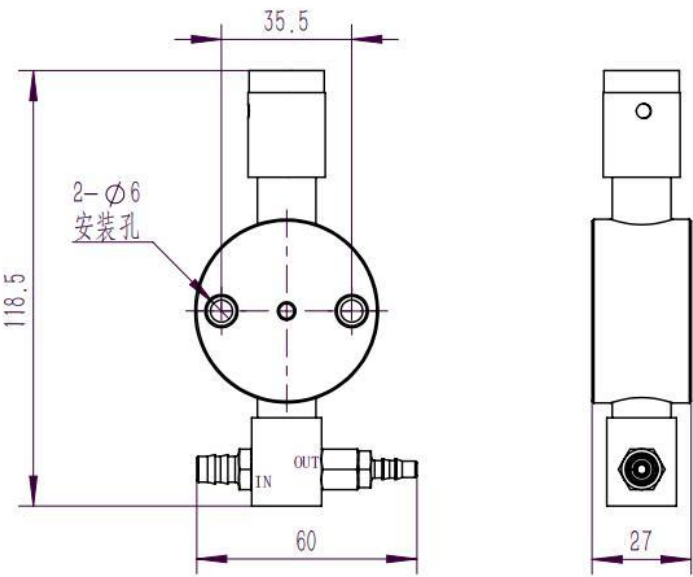

Struture diagram

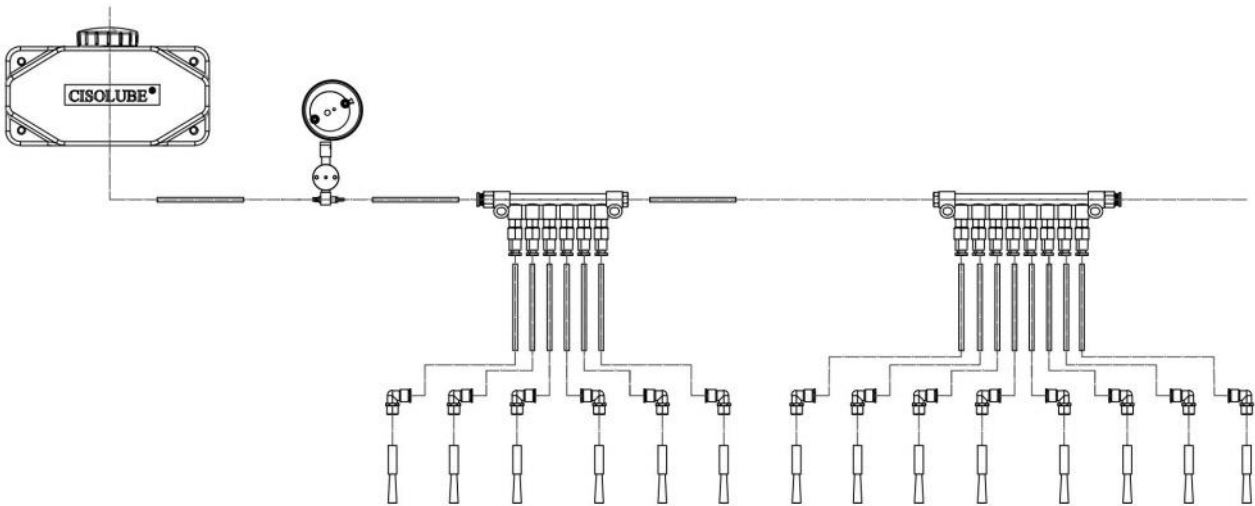

Ordering information

PN.	Part number	Order number	Description
Pump	PMM	27050	Max.2ml / time;Max.280 rpm/min
CAM	CAM	27051	8 preset outputs



Characteristics

- Dosing elements are required
- Material: Aluminum
- Small size
- Adjustable displacement
- Suitable for harsh environments
- Immediate response

PIISTON PUMP WITH CAM DRIVE

Simple design, strong structure, easy to install, especially suitable for agricultural machinery.

Use in harsh environments.

The PMN lubrication system made up of a 4 or 7 litre reservoir with suction filter, metering pieces and brushes Lubrication system, the demand of each lubrication point can be adjusted by adjusting the metering parts .The volume can be set, and the total system can also be adjusted by the PMN plunger motion stroke Total oil output.

The PMN system is especially suitable for the chain lubrication requirements of agricultural equipment such as round baler and harvester. For the reason that the push rod is driven by the drive device on the side of the rear compartment door, the drive system follows the stroke of the piston (15mm maximum) and the maximum number of strokes (5 strokes / minute).

PMN lubrication pumps are also suitable for other lubrication requirements, such as gearbox, guide rail, chain, etc., and also for applications that need to maintain constant pressure lubrication.



Application

- Bundling machine
- Combine harvester
- Pickup machine
- Field mower
- Fertilizer applicator

Advantage

- No motors and controller
- Significantly reduce maintenance costs
- Simple installation, small size
- Metered lubrication of each area as required
- Protect the lubricated parts with an uninterrupted frequency

Dimensions(mm)

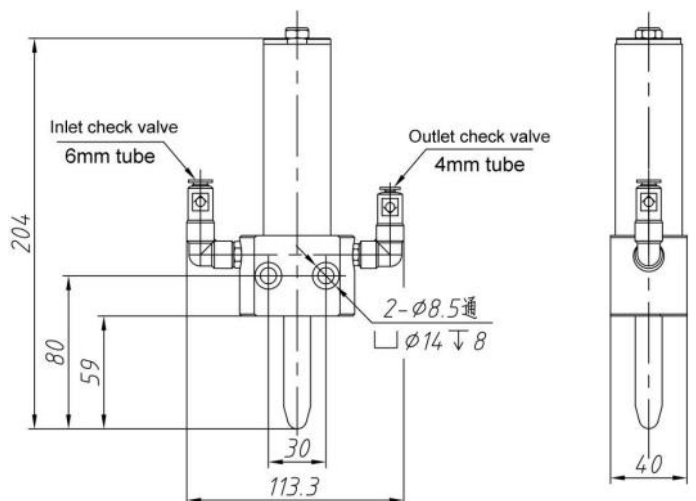

PMN multi-line chain lubrication pump

Technical parameters

Rated pressure: 10 Bar

Rated flow: 10ml/cyc

Stroke: 15mm

Maximum stroke: 5cyc/min

Ordering information

P.N	Part number	Order number	Description
Pump	PMN	28051	

Struture diagram

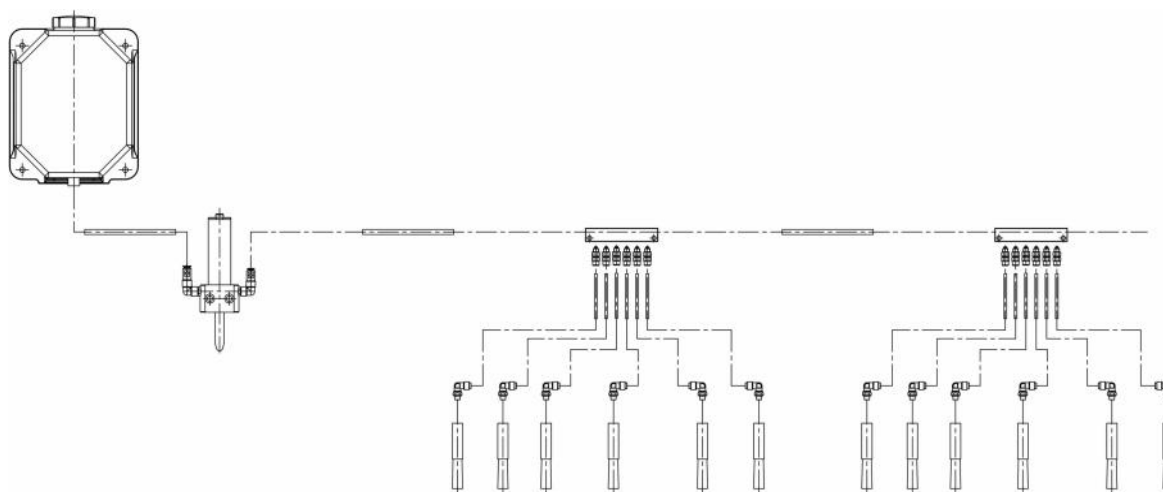

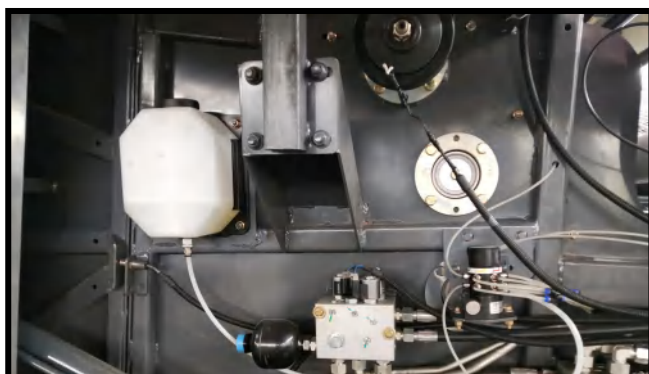
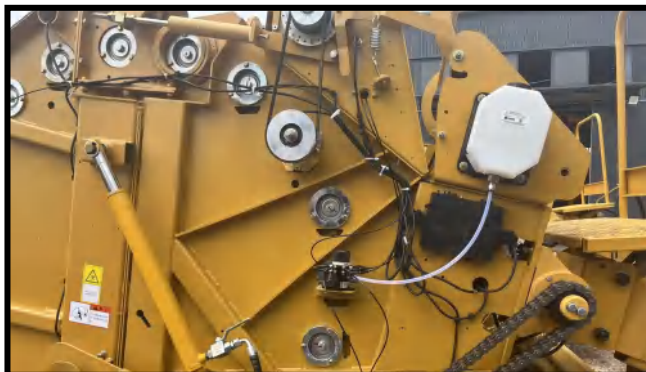
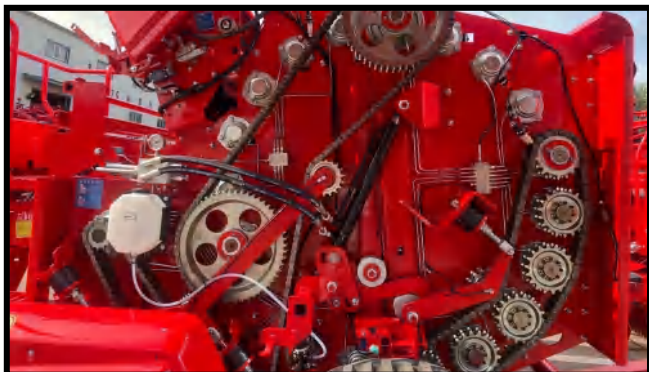



SIMPLE SOLUTIONS to
PRECISE LUBRICATION

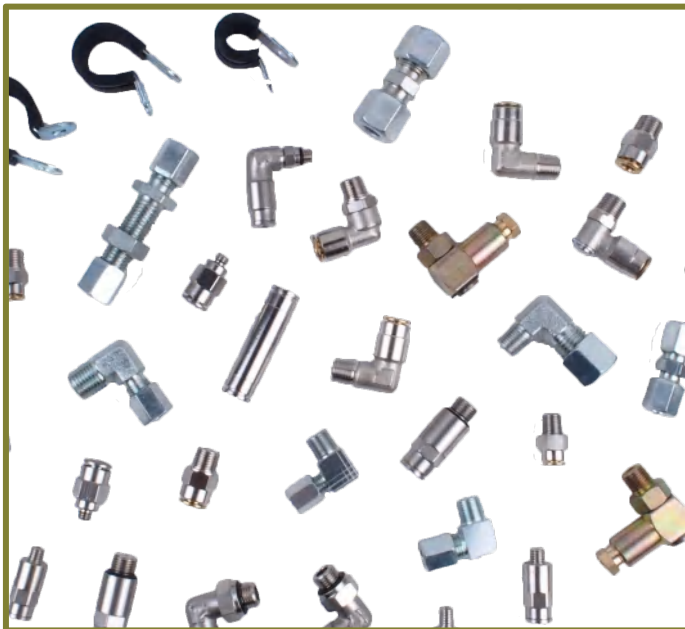

Electric lubrication pump accessories

Pump outlet assembly



Grease filling connector



Part number	Description	Pressure	OD
80533PG	With pressure gauge	275bar/ 4000psi	6mm
80533PG-8			8mm
80533	Without pressure gauge		6mm
80533-8			8mm

Part number	Description	Thread
80220	Male connector	G1/4
80221	Female connector	G1/4

GT Pumping Element



GM Pumping Element



Part number	OD	Rated flow
80536	6mm	A6; 4ml/min
80537	7mm	A7; 5ml/min

Part number	OD	Rated flow
88535	5mm	P5; 3.3ml/min
88536	6mm	P6; 4ml/min



Safety valve

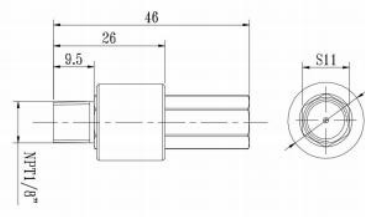

Part number	Pressure	Male thread
5FI07	275bar/4000psi	M10*1

Part number	OD	Male thread	Pressure
5FJ01	φ6	G1/4	345bar/5000psi



Mounting bracket



Description	Part number	Type
Mounting bracket	90236	GT
	90235	GM

Button with green lamp



Description	Part number
12V	90212
24V	90224

Cartridge



Description	Part number	Reservoir
Cartridge	CSL-J100	700CC
	CSL-C100	700CC

Alarm output cable



Description	Part number
M12X1; 4Core; 2M	13702

Pressure switch

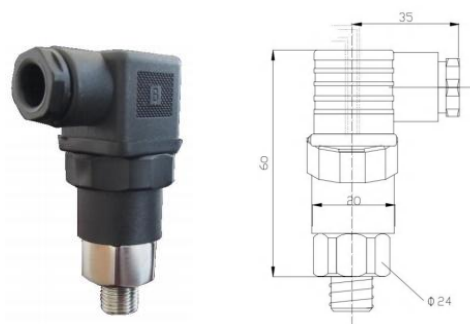

Description	Part number
Adjustable Type	91346

Wiring diagram

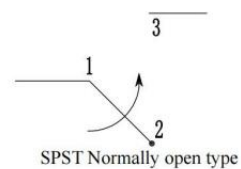
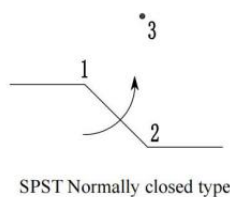
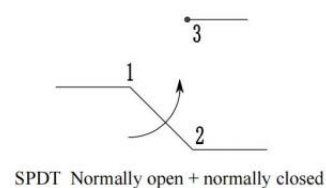
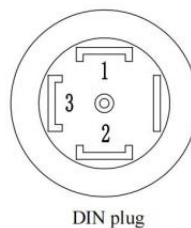

Pump connection cable



Description	Part number
DIN; 4Core; 3M	12703
DIN; 4Core; 10m	12710
DIN; 4Core; 15M	12715



Grease lubrication system accessories

Lubrication system accessories

Straight fitting with check valve
25Mpa

Push in



Part number	OD	Thread	Material
FP1104M10	Ø4	M10*1	Zinc plated
FP1106M10	Ø6	M10*1	Zinc plated

Straight fitting

Push in 25Mpa



Part number	OD	Thread	Material
HPQ1106M10	Ø6	M10*1	Zinc plated

Straight fitting with check valve

25Mpa

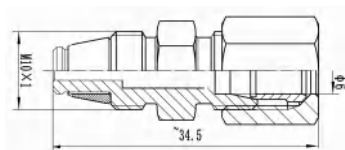

Part number	OD	Thread	Material
5CM0610	Ø6	M10*1	zinc-nickel, brass

Straight fitting with check valve

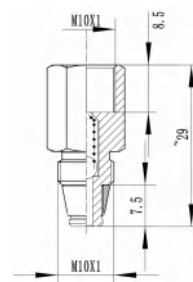

Part number	F.Thread	M.Thread	Material
5DC10	M10*1	M10*1	zinc-nickel, brass

Straight fitting assembly

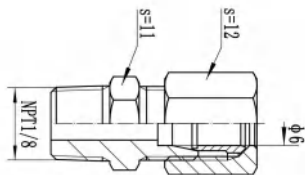

Part number	OD	Thread	Material
5PM0610	Ø6	NPT1/8	Zinc plated

Straight fitting with check valve

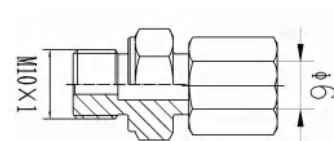

Part number	OD	Thread	Material
5VM0610	Ø6	M10*1	Zinc-nickel plated steel



Straight fitting assembly

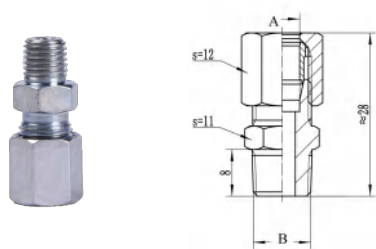

Part number	OD	Thread	Material
5DM0602	Ø6	R1/8	Zinc plated
5DM0610	Ø6	M10*1	Zinc plated
5DM0608	Ø6	M8*1	Zinc plated
5DM0606	Ø6	M6*1	Zinc plated
5DM0402	Ø4	R1/8	Zinc plated
5DM0410	Ø4	M10*1	Zinc plated
5DM0408	Ø4	M8*1	Zinc plated
5DM0406	Ø4	M6*1	Zinc plated

Angle fitting assembly

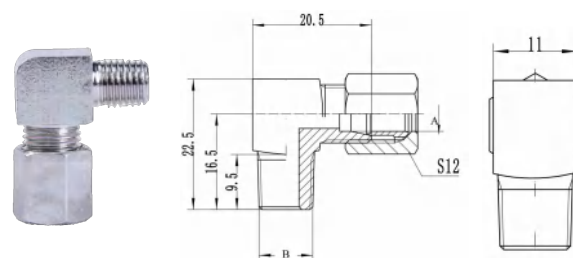

Part number	OD	Thread	Material
5HM0602	Ø6	R1/8	Zinc plated
5HM0610	Ø6	M10*1	Zinc plated
5HM0608	Ø6	M8*1	Zinc plated
5HM0606	Ø6	M6*1	Zinc plated
5HM0402	Ø4	R1/8	Zinc plated
5HM0410	Ø4	M10*1	Zinc plated
5HM0408	Ø4	M8*1	Zinc plated
5HM0406	Ø4	M6*1	Zinc plated

Straight fitting

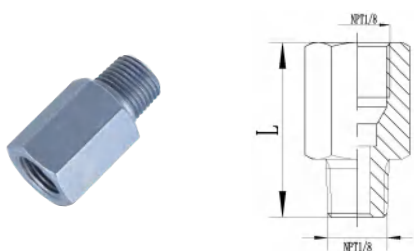

Part number	Thread	Thread	Material	L
5GN02	NPT1/8	NPT1/8	Zinc-nickel plated steel	27
5G0202	NPT1/8	NPT1/8		19

Angle fitting assembly

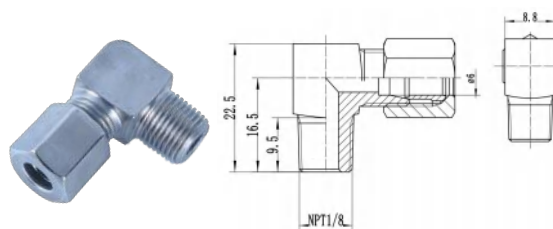

Part number	OD	Thread	Material
5NM0610	Ø6	NPT1/8	Zinc plated



Grease lubrication system accessories

Straight fitting



Part number	OD	Thread	Material
5SF0610	Ø6	M10*1	Zinc plated

BANJO with grease nipple inlet assembly:



Part number	Thread M
31M10	M10x1
31M18	G1/8

Straight fitting

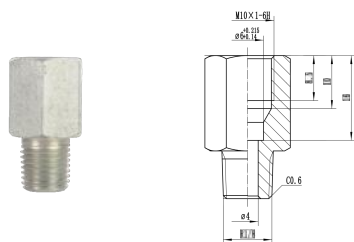

Part number	Thread M	Thread F	Material
5G0210	R1/8	M10*1	Zinc plated
5G0808	M8*1	M8*1	
5G0404	R1/4	R1/4	
5G1010	M10*1	M10*1	

Adjustable fitting



Part number	OD	Thread M
5B0610	Ø6	M10*1

BANJO



Part number	OD	Thread M	Material
5C0602	Ø6	R1/8	Zinc Color-plated
5C0610	Ø6	M10*1	

Straight tube-to-tube connectors

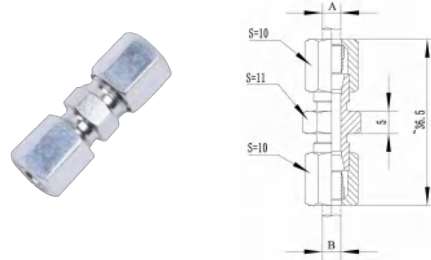

Part number	OD	OD	Material
5D0404	Ø4	Ø4	Zinc plated
5D0406	Ø4	Ø6	Zinc plated
5D0606	Ø6	Ø6	Zinc plated
5D0608	Ø6	Ø8	Zinc plated
5D0808	Ø8	Ø8	Zinc plated



Elbow Connector 45°

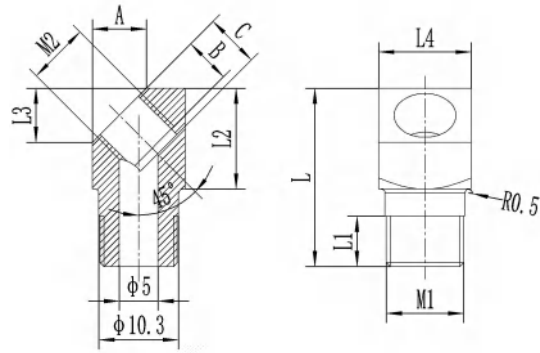

Part number	M1	M2	L	L1	L2	L3	L4	A	B	C
5EM0808	ZM8*1	M8*1	23	6.5	13	7	12	7	6	7
5EM0410	ZM10*1	M8*1	23	6.5	13	7	12	7	6	7
5EM1010	ZM10*1	M10*1	23	6.5	13	7	12	7	6	7
5EM0202	ZG1/8	ZG1/8	23	6.5	13	7	12	7	6	7
5EM0404	ZG1/4	ZG1/4	33	6.5	18	7	12	7	6	7

Angle Connector 90°

9GM10

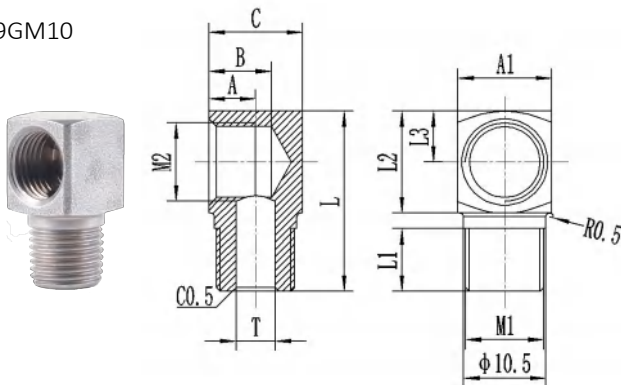

9GM10-Z

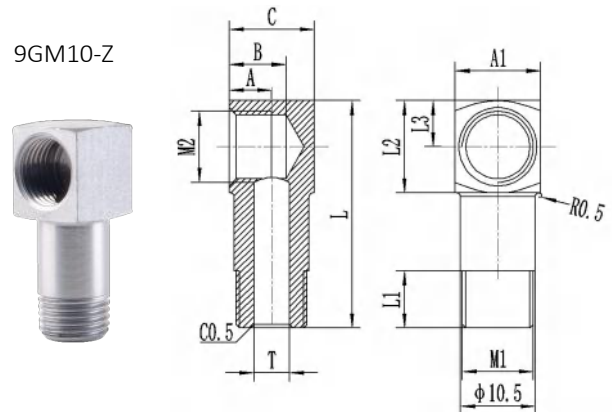

Part number	M1	M2	L	L1	L2	L3	A	B	C	A1
9GM0808	ZM8*1	M8*1	23	8	13	6.5	6	8	12	12
9GM1008	ZM10*1	M8*1	23	8	13	6.5	6	8	12	12
9GM10	ZM10*1	M10*1	23	8	13	6.5	6	8	12	12
9GM10-Z	ZM10*1	M10*1	32	8	13	6.5	6	8	12	12
9GM0202	ZG1/8	ZG1/8	23	8	13	6.5	6	8	12	12
9GM0404	ZG1/4	ZG1/4	33	8	18	6.5	6	8	12	17



Grease lubrication system accessories

Extension fitting assembly

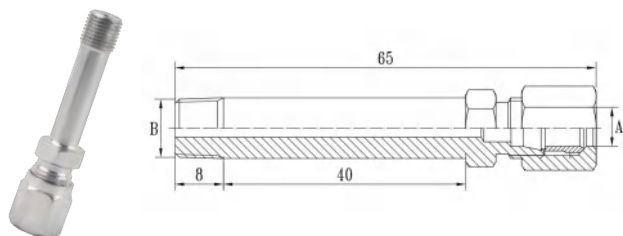

Part number	OD	Thread M	Material
5KM0602	Ø6	R1/8	Zinc plated
5KM0610	Ø6	M10*1	Zinc plated
5KM0608	Ø6	M8*1	Zinc plated
5KM0606	Ø6	M6*1	Zinc plated
5KM0402	Ø4	R1/8	Zinc plated
5KM0410	Ø4	M10*1	Zinc plated
5KM0408	Ø4	M8*1	Zinc plated
5KM0406	Ø4	M6*1	Zinc plated

MP11 Taper Straight, Male 10Mpa

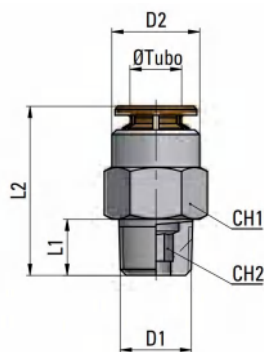

Part number	OD	D1	D2	L1	L2
MP110418	Ø4	R1/8	9	7.5	18.5
MP1104M6	Ø4	M6*1.0	9	8	23
MP1104M8	Ø4	M8*1.0	9	8	20
MP1104M10	Ø4	M10*1.0	9	8	20
MP110618	Ø6	R1/8	12	7.5	21.5
MP1106M6	Ø6	M6*1.0	12	8	25.5
MP1106M8	Ø6	M8*1.0	12	8	25.5
MP1106M10	Ø6	M10*1.0	12	8	22



HP11 Taper Straight, Male 25Mpa

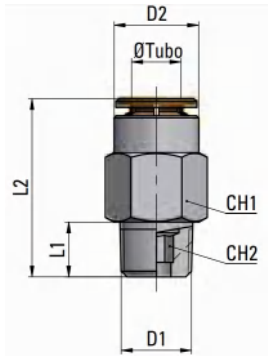

Part number	OD	D1	D2	L1	L2
HP110418	Ø4	R1/8	9.5	7.5	21
HP1104M6	Ø4	M6*1.0	9.5	8	25
HP1104M8	Ø4	M8*1.0	9.5	8	25
HP1104M10	Ø4	M10*1.0	9.5	8	22.5
HP110618	Ø6	R1/8	11.5	7.5	24
HP1106M6	Ø6	M6*1.0	11.5	8	28
HP1106M8	Ø6	M8*1.0	11.5	8	28
HP1106M10	Ø6	M10*1.0	11.5	8	24.5

MP14 Taper Elbow Fitting, Male 10Mpa

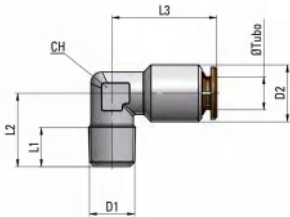

Part number	OD	D1	D2	L1	L2
MP140418	Ø4	R1/8	9	7.5	15.5
MP1404M6	Ø4	M6*1.0	9	8	17
MP1404M8	Ø4	M8*1.0	9	8	17
MP1404M10	Ø4	M10*1.0	9	8	18
MP140618	Ø6	R1/8	12	7.5	15.5
MP1406M6	Ø6	M6*1.0	12	8	17
MP1406M8	Ø6	M8*1.0	12	8	17
MP1406M10	Ø6	M10*1.0	12	8	18



Grease lubrication system accessories

HP14 Taper Elbow Fitting, Male 25Mpa

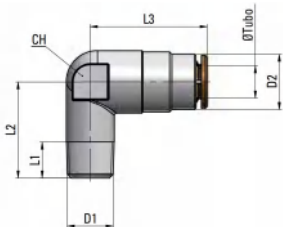

Part number	OD	D1	D2	L1	L2
HP140418	Ø4	R1/8	9.5	7.5	17
HP1404M6	Ø4	M6*1.0	9.5	8	17
HP1404M8	Ø4	M8*1.0	9.5	8	17
HP1404M10	Ø4	M10*1.0	9.5	8	18
HP140618	Ø6	R1/8	11.5	7.5	20
HP1406M6	Ø6	M6*1.0	11.5	8	20
HP1406M8	Ø6	M8*1.0	11.5	8	20
HP1406M10	Ø6	M10*1.0	11.5	8	21

MP15 Taper Elbow Fitting, Male, Rotatable 10Mpa

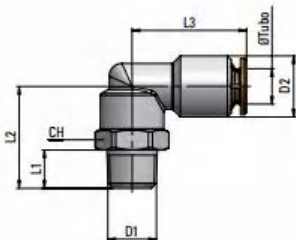

Part number	OD	D1	D2	L1	L2
MP150418	Ø4	R1/8	9	7.5	20
MP1504M6	Ø4	M6*1.0	9	8	20.5
MP1504M8	Ø4	M8*1.0	9	8	20.5
MP1504M10	Ø4	M10*1.0	9	8	20.5
MP150618	Ø6	R1/8	12	7.5	20
MP1506M6	Ø6	M6*1.0	12	8	21.5
MP1506M8	Ø6	M8*1.0	12	8	21.5
MP1506M10	Ø6	M10*1.0	12	8	21.5



HP18 Taper Elbow Fitting, Male, Rotatable 25Mpa

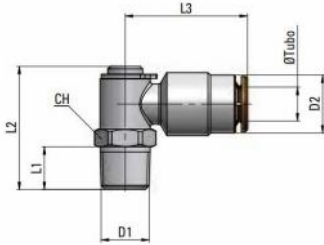

Part number	OD	D1	D2	L1	L2
HP180418	Ø4	R1/8	9.5	8.5	22
HP1804M6-1	Ø4	M6*0.75	9.5	6	22
HP1804M6	Ø4	M6*1	9.5	8	22
HP1804M8	Ø4	M8*1	9.5	8	22
HP1804M10	Ø4	M10*1	9.5	8	22
HP180618	Ø6	R1/8	11.5	8.5	24
HP180614	Ø6	R1/4	11.5	11	24
HP1806M6	Ø6	M6*1	11.5	8	24
HP1806M8	Ø6	M8*1	11.5	8	24
HP1806M10	Ø6	M10*1	11.5	8	24

Hose coupling straight

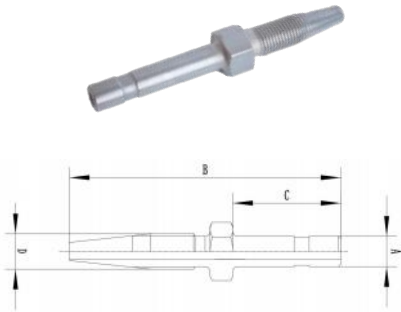

Part number	A	B	C	D	Material
ZZ06	Ø6	60	30	M7*1	Zinc-nickel plated
ZZ06-1(Short)	Ø6	54.5	21.5	M7*1	
ZZ0610	Ø6	63	30	M10*1	
ZZ08	Ø8	63	30	M10*1	



Grease lubrication system accessories

Hose coupling bent

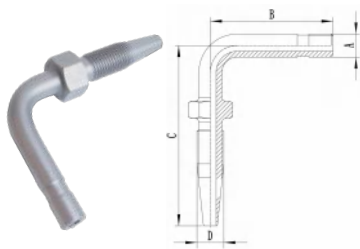

Part number	A	B	C	D	Material
WZ06	Ø6	32	45	M7*1	Zinc-nickel plated
WZ0610	Ø6	32	45	M10*1	
WZ06-1(Short)	Ø6	20	45	M7*1	
WZ08	Ø8	35	50	M10*1	

135°Hose coupling bent

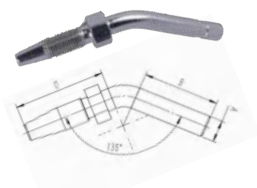

Part number	Pipe diameter	B	C	D	Material
WZ13506	Ø6	30	36	M7*1	Zinc-nickel plated

Threaded sleeve

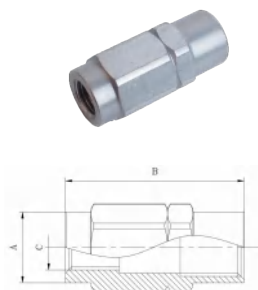

Part number	Pipe diameter	B	C	D	Material
WO06	Ø6	Ø11	28	M7*1	Zinc-nickel plated
WO08	Ø8	Ø14	28	M10*1	

Inset filter:

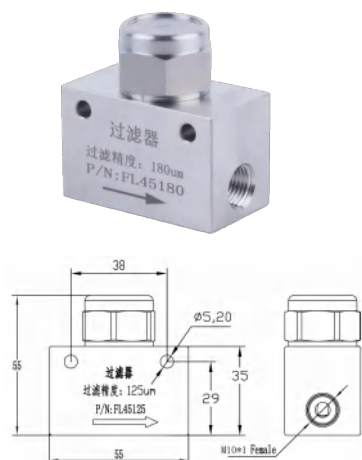

Part number	Rate	Thread F	Material
AL45180	180µm	M10*1	AL
AL45125	125µm	M10*1	

To order filters with other rate, please contact your sales manager.



Ferrule



Part number	Thread	TUBE O.D.	MPa
NLL-08	M8*1	Ø4	Super light series LL
NLL-10	M10*1	Ø6	
NL-12	M12*1.5	Ø6	Light series L
NL-14	M14*1.5	Ø8	
NL-16	M16*1.5	Ø10	
NL-18	M18*1.5	Ø12	

Nuts



Part number	TUBE O.D.	MPa
RLL-04	Ø4	Super light series LL
RLL-06	Ø6	
RL-06	Ø6	Light series L
RL-08	Ø8	
RL-10	Ø10	
RL-12	Ø12	

Plane-end plug

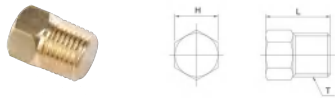

Part number	L	T	H
3G0408	12	M8*1.0	8
3G0601	14	PT1/8	10

Sleeve pipe plug

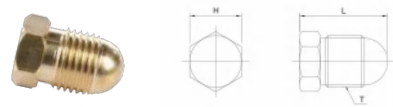

Part number	L	T	H
3G04	16	M8*1.0	8
3G06	17	M10*1.0	10



Grease lubrication system accessories

Straight Fitting assembly



Part number	Ø Tubo	Thread
3D0410T	Ø4	M10*1
3D0610T	Ø6	M10*1
3D0408T	Ø4	M8*1.0
3D0406T	Ø4	M6*1.0

Sleeve pipe cap

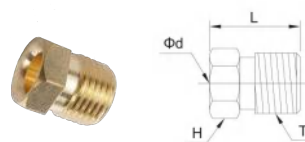

Part number	OD	Ød	ØD	L
3A04	4	4.1	12	4.5
3A06	6	6.1	12.5	5
3A08	8	8.1	14	7
3A10	10	10.1	15	8

Sleeve pipe

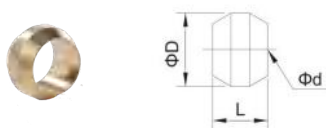

Part number	OD	Ød	ØD	L
3B04	4	4.1	6	4.5
3B06	6	6.1	8	5
3B08	8	8.1	11	7
3B10	10	10.1	13.5	8

Inner screw of pipe

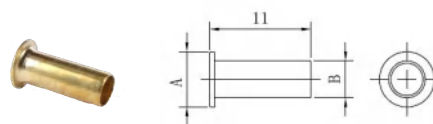

Part number	A	B
BF04	4	2
BF0425	4	2.5
BF06	6	4
BF0630	6	3



High-pressure flexible pipe



Part number	Outer diameter	Inside diameter
T-HP03	Ø6	Ø3
T-HP04	Ø8.6	Ø4
T-HP06	Ø11	Ø6.3

Nylon tubing (BP in black; WP in white)



Part number	Outer diameter	Inside diameter
T-BP06	Ø6	Ø3
T-BP04	Ø4	Ø2.5
T-WP06	Ø6	Ø4
T-WP04	Ø4	Ø2

Steel tubing



Part number	Outer diameter	Inside diameter
T-CP04	Ø4	Ø2
T-CP06	Ø6	Ø4
T-CP08	Ø8	Ø6
T-CP10	Ø10	Ø8

Spring coil



Part number	Ød	Suitable pipe outer diameter
THT04	4.5	4
THT06	6.5	6
THT08	11	9.3



Grease lubrication system accessories

Flat hose plastic jacket



Part number	Ød	Suitable pipe outer diameter
THL08-1	8	6
THL10-1	10	8.6
THL12-1	12	11.2

Cable tie



Part number	Width	Length	Material
ZDCH5200	5	200	Nylon
ZDCH5300	5	300	
ZDCH5500	5	500	

R Pipe clamp



Part number	Ød	Mounting hole
RC06	6	6.4mm
RC08	8	6.4mm
RC10	10	6.4mm
RC12	12	6.4mm
RC14	14	6.4mm
RC16	16	6.4mm
RC18	18	6.4mm
RC20	20	6.4mm
RC22	22	6.4mm
RC25	25	6.4mm
RC28	28	6.4mm
RC30	30	6.4mm



DSM metering devices

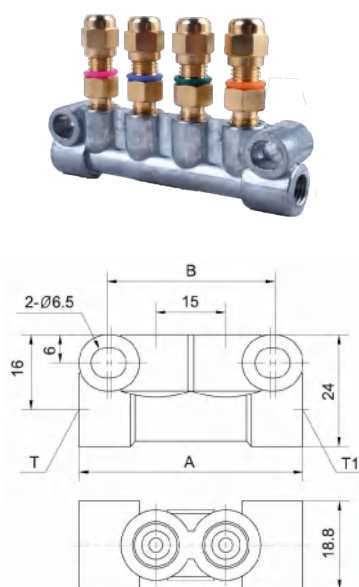

Part number	T/T1	OD	Outlets number	Flow pattern	A	B
DSM metering devices	M8X1	Ø4	2	00 0 1 2 3 4 5	48	34.5
	M8X1	Ø4	3		64	50.5
	M8X1	Ø4	4		80	66.5
	M8X1	Ø4	5		96	82.5
	M8X1	Ø4	6		112	98.5
	M8X1	Ø4	7		128	114.5
	M8X1	Ø4	8		144	130.5

The base material is cast iron

Ordering info

example: DSM-1M*4-Q4-4T

Outlet number
Q=Push-in Fitting S=Sleeve nut fitting
Metering device flow form*quantity
Product series name

DSMT metering devices

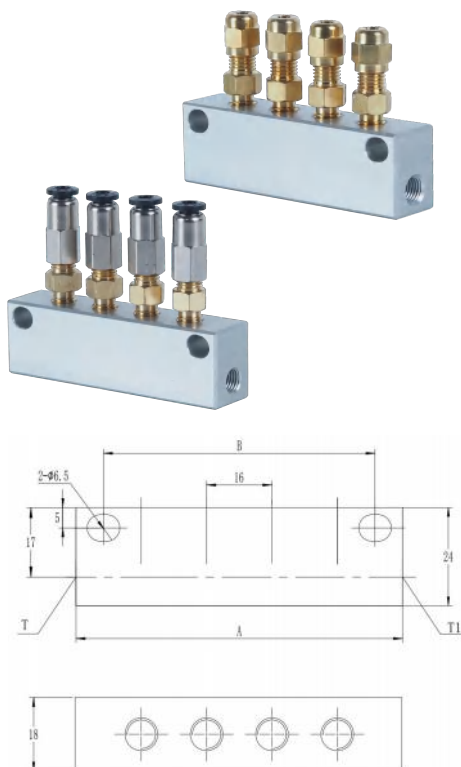

Part number	T1/T2	OD	Outlets number	Flow pattern	A	B
DSMT metering devices	M8X1	Ø4	2	00 0 1 2 3 4 5	48	34.5
	M8X1	Ø4	3		64	50.5
	M8X1	Ø4	4		80	66.5
	M8X1	Ø4	5		96	82.5
	M8X1	Ø4	6		112	98.5
	M8X1	Ø4	7		128	114.5
	M8X1	Ø4	8		144	130.5

The base material is aluminum

Ordering info

example: DSMT-1M*4-Q4-4T

Outlet number
Q=Push-in Fitting S=Sleeve nut fitting
Metering device flow form*quantity
Product series name



Chain lubrication system accessories

Reservoir 4L



Part number

Technical specifications

RV08E04

Outlet OD 8mm; With filter

RV10E04

Outlet OD10mm; With filter

Reservoir 7L



Part number

Technical specifications

RV08E07

Outlet OD 8mm; With filter

RV10E07

Outlet OD10mm; With filter

Elbow Fitting, male 2Mpa

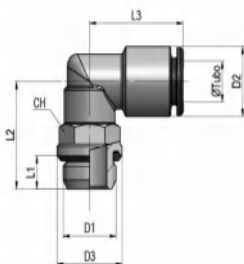

Part number

OD

D1

D2

L1

L2

Usage

AP160418

Ø4

G1/8

9

7.5

20

Pump outlet,
brush

Straight Push-in fitting , male 2Mpa

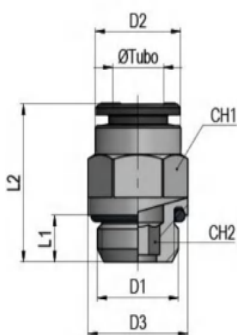

Part number

OD

D1

D2

L1

L2

Usage

AP120814

Ø8

G1/4

12

8

25.5

Reservoir outlet

AP121014

Ø10

G1/4

12

8

25.5

Reservoir outlet

AP120418

Ø4

G1/8

9

7.5

18.5

Pump outlet,
brush

AP120818

Ø8

G1/8

9

8

20

Pump inlet

AP121018

Ø10

G1/8

12

8

25.5

Pump inlet

Tee Fitting

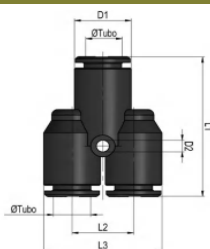

Part number

OD

D1

D2

L1

L2

L3

AP290404

Ø4

10

3.13

31.5

10

19.5



Brushes

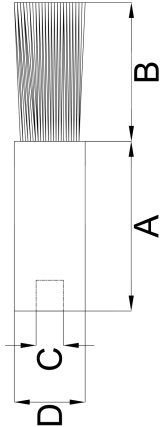

Part number	A	B	C	D	Material
MS-B01	55	44.8	G1/8	16	NYLON
MS-B02	55	44.8	G1/8	23	NYLON

Felt

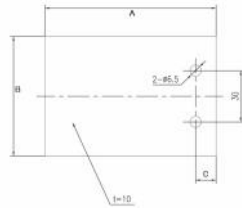

Part number	A	B	C	T
FT50	70	50	11	10
FT70	100	70	12	10

Coupling bolt

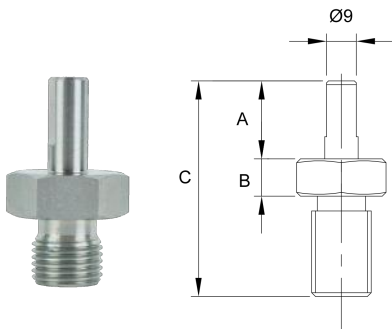

Part number	Male thread	A	B	C
M14*2L61	M14*2	21	10	61
M16*1.5L46	M16*1.5	21	10	46
M16*1.5L58	M16*1.5	21	10	58
M16*2L58	M16*2	21	10	58

Nylon Tubing
(BP in black; WP in white)

Part number	Piping outer diameter	Piping Inside diameter
T-BP04	Ø4	Ø2.5
T-BP06	Ø6	Ø3
T-BP08	Ø8	Ø6
T-BP10	Ø10	Ø8
T-WP04	Ø4	Ø2.5
T-WP06	Ø6	Ø3
T-WP08	Ø8	Ø6
T-WP10	Ø10	Ø8



Chain lubrication system accessories

Plastic helix



Part number	Ød	Piping outer diameter
THL04	4	4
THL06	6	6
THL08	8	8.6
THL10	10	11

R Pipe clamp



Part number	Ød	Mounting hole
RC06	6	6.4mm
RC08	8	6.4mm
RC10	10	6.4mm
RC12	12	6.4mm
RC14	14	6.4mm
RC16	16	6.4mm
RC18	18	6.4mm
RC20	20	6.4mm
RC22	22	6.4mm
RC25	25	6.4mm
RC28	28	6.4mm
RC30	30	6.4mm

Cable tie



Part number	Width	Length	Material
ZDCH5200	5	200	Nylon
ZDCH5300	5	300	
ZDCH5500	5	500	





Yantai CISO Lubrication Technology Co.,Ltd

No. 30 Chuangye Road, High-tech Zone, Yantai, Shandong

Tel:+086 400-800-9400



MADE IN CHINA

